



**DSD-201™,  
DSD-201LT™**  
Endoscope Reprocessor  
Domestic, U.S. only

This document is designed to provide a quick reference to the major replacement parts and components for the DSD-201. It does not include some of the smaller items such as screws and washers.

To order parts or place a Technical Service call, contact Medivators Technical Support at 800-444-4729 Option 2.

## Contents

Description	Page
Electronic Circuit Boards & Accessories	4
Leak Tester Assembly	9
DSD Front View	11
DSD Top View	12
Basin, Top View	13
Basin, Underside View	14
$\frac{3}{4}$ " Valve Manifold Details (includes 1 <sup>st</sup> , 2 <sup>nd</sup> & 3 <sup>rd</sup> generation)	15
Station A Main Module Assembly	21
Station B Main Module Assembly	22
Detail of Main 6 Valve Manifold	23
2 Valve Manifold	27
Alcohol / Detergent and Internal Water Filter Assembly	28
LCG Reservoir Assembly	33
Air Tank	36
GFI	37

## Electronic Circuit Boards & Accessories

Item		Part Number
Pg #	PC Boards	
	CPU with Temperature Monitor	MB01-0016
	Digital I/O	MB01-0017
	Sensor	MB01-0018
	Leak Tester (S.I.T.)	MB01-0020
	Control Panel	MB01-0022
	Key Pad	36030-020
	Valve Drive	MB01-0019
	5VDC Power Supply	MS06-0003
	24VDC Power Supply	MS06-0005
Cables		
	Digital Output / Sheath / Sensor	MC08-0510
	CPU / Valve / Do Ribbon	MC08-0511
	Valve Board Interconnect	MC08-0512
	Control Panel Bus Line	MC08-0508
	Main Harness Side A	MH05-0039
	Main Harness Side B	78398-871
Fuses		
	Main fuse	
	1 ½ Amp	MF02-0004
	Valve Drive Board Fuses	
F1	3.15 Amp	MF02-0014
F2	5 Amp (110volt)	MF02-0017
F3	3.15	MF02-0014
	Air tank wiring harness fuse	
	6.25 amp	MF01-0018

Main electronic panel assy: ASM1-0089

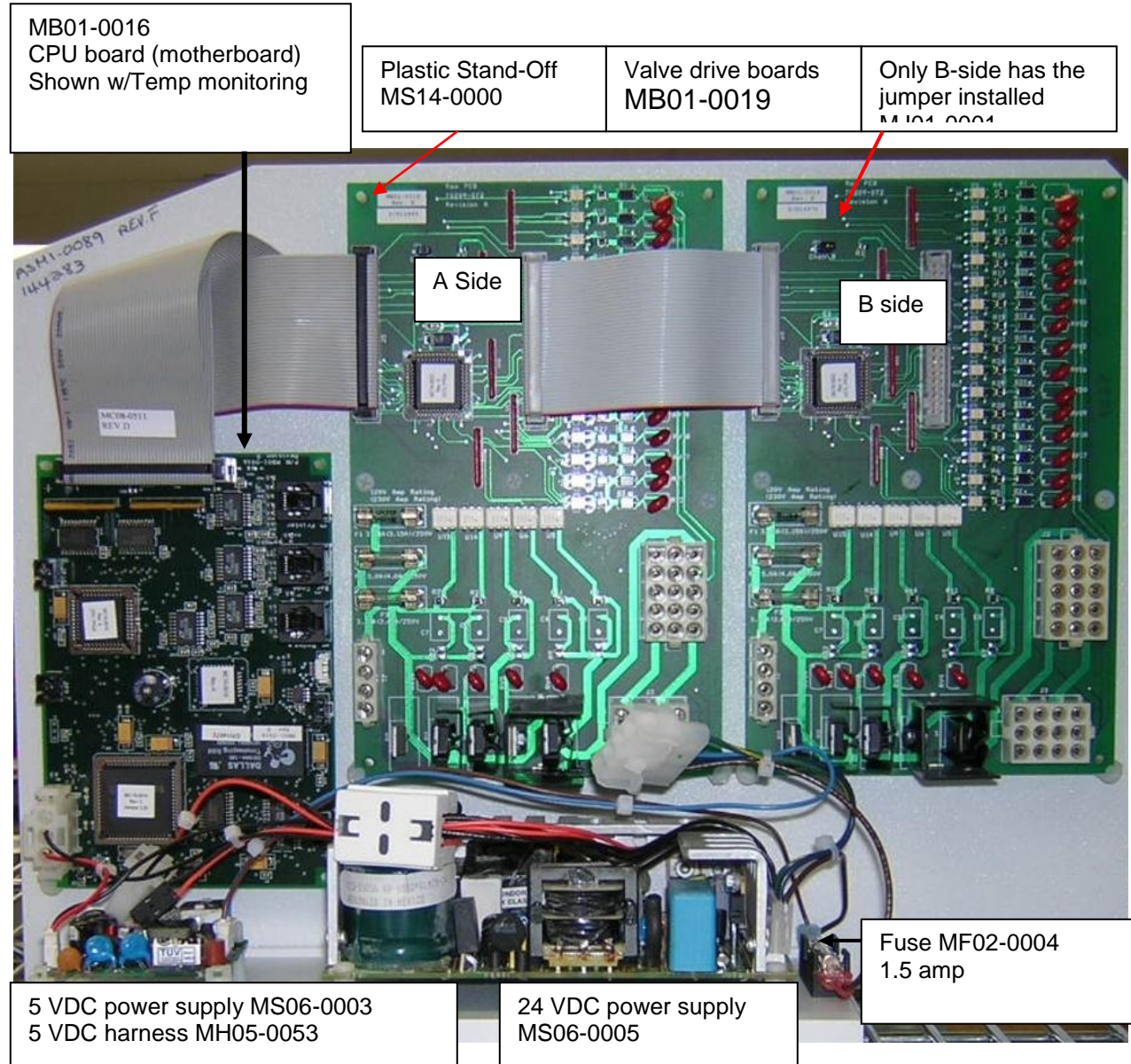

Close up of Fuses

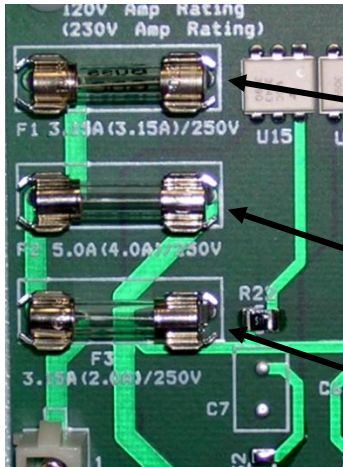

F1 (Valves)  
Fuse MF02-0014  
3.15 amp

F2 (Pump/Comp) 5 amp  
Fuse MF02-0017

F3 (Heater)  
Fuse MF02-0014  
3.15 amp

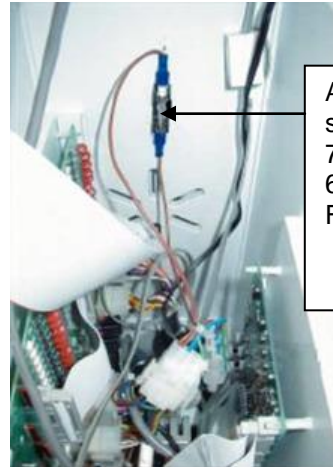

Air line pressure  
switch harness  
78398-481  
6.25 Amps  
Fuse MF02-0018

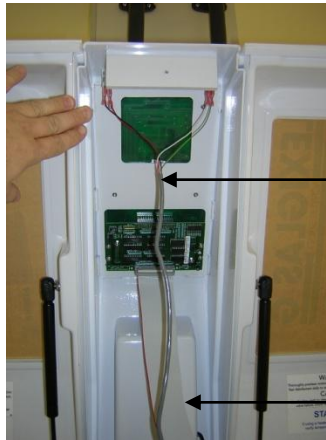

Indicator Light Cable  
MH05-0045

Interconnect Cable:  
Control to Valve Board  
MC08-0508



Secondary electronic assy: ASM1-0090  
With Leak tester board.

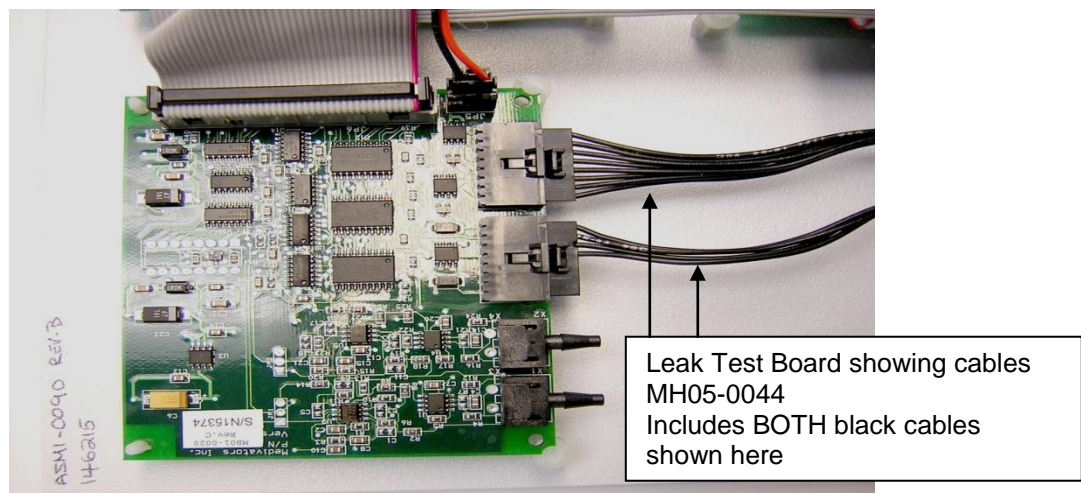
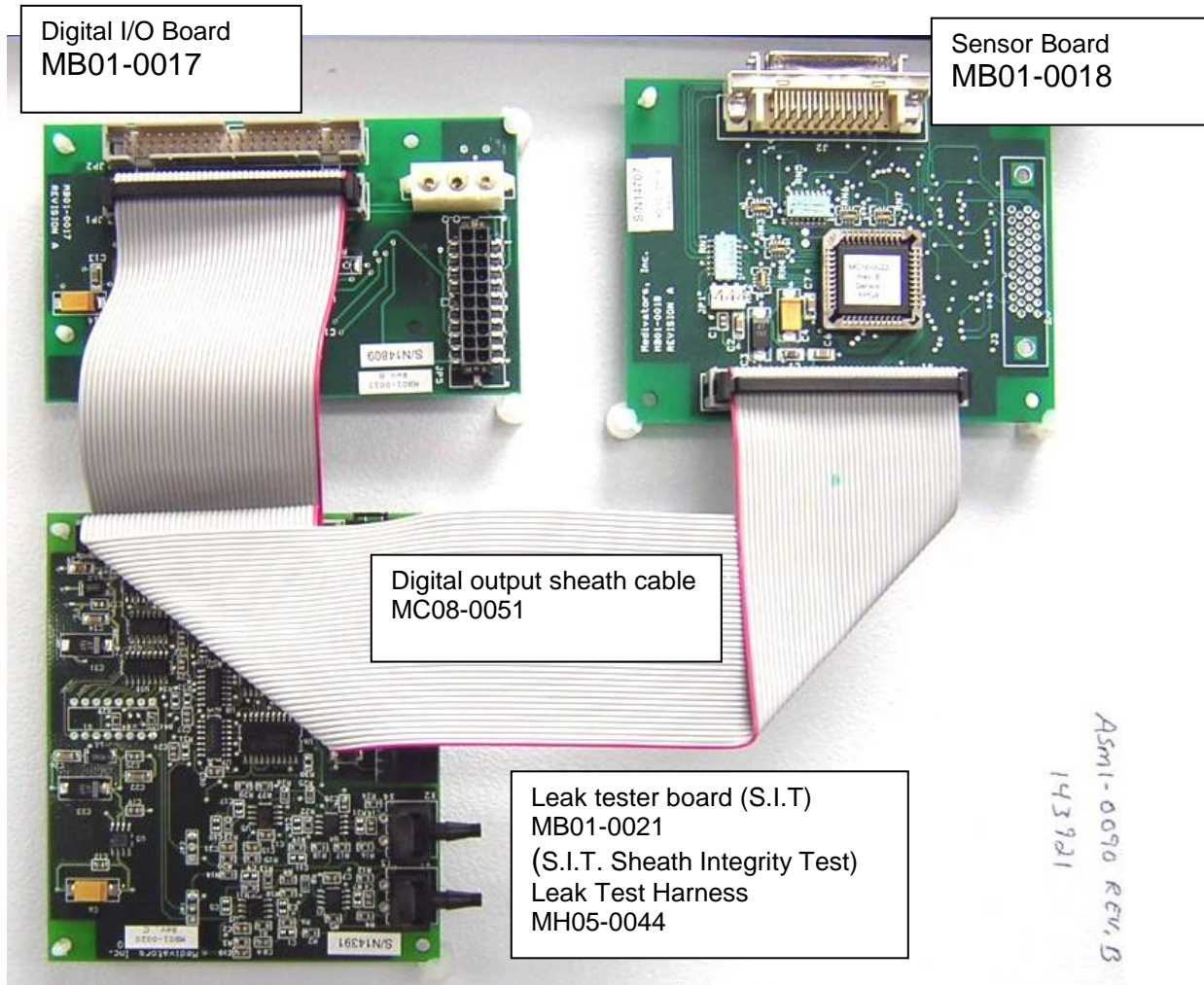



Secondary Electronic panel

Without Leak Tester bd.  
ASM1-0207

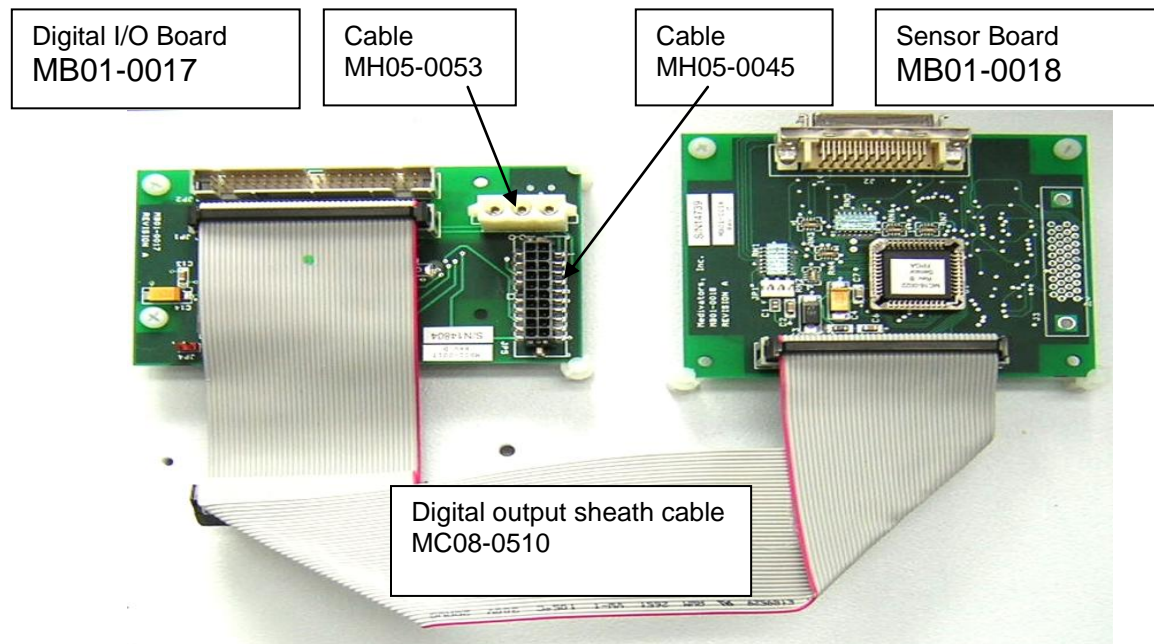

## Leak Tester assembly: ASM1-0080 **OBSOLETE**

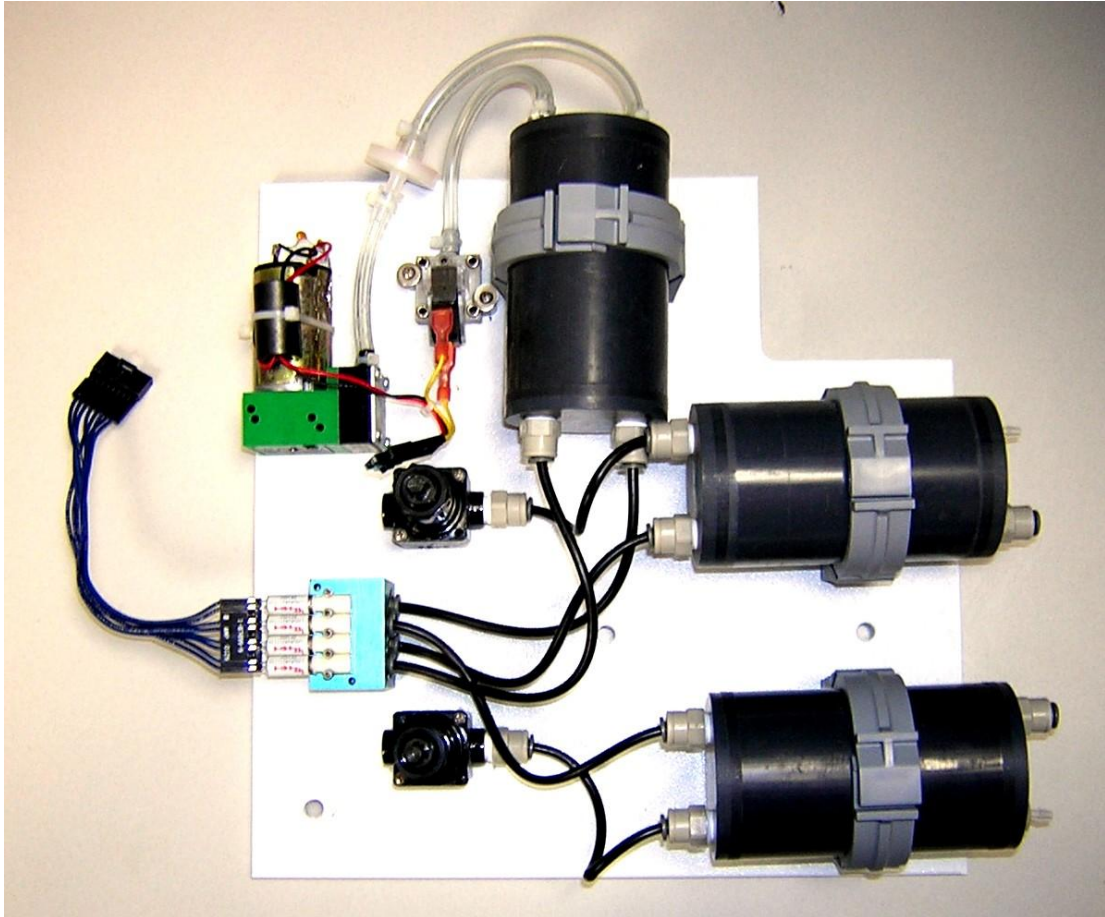

See next page for replacement

## Second Generation Leak Test Assembly

78399-461

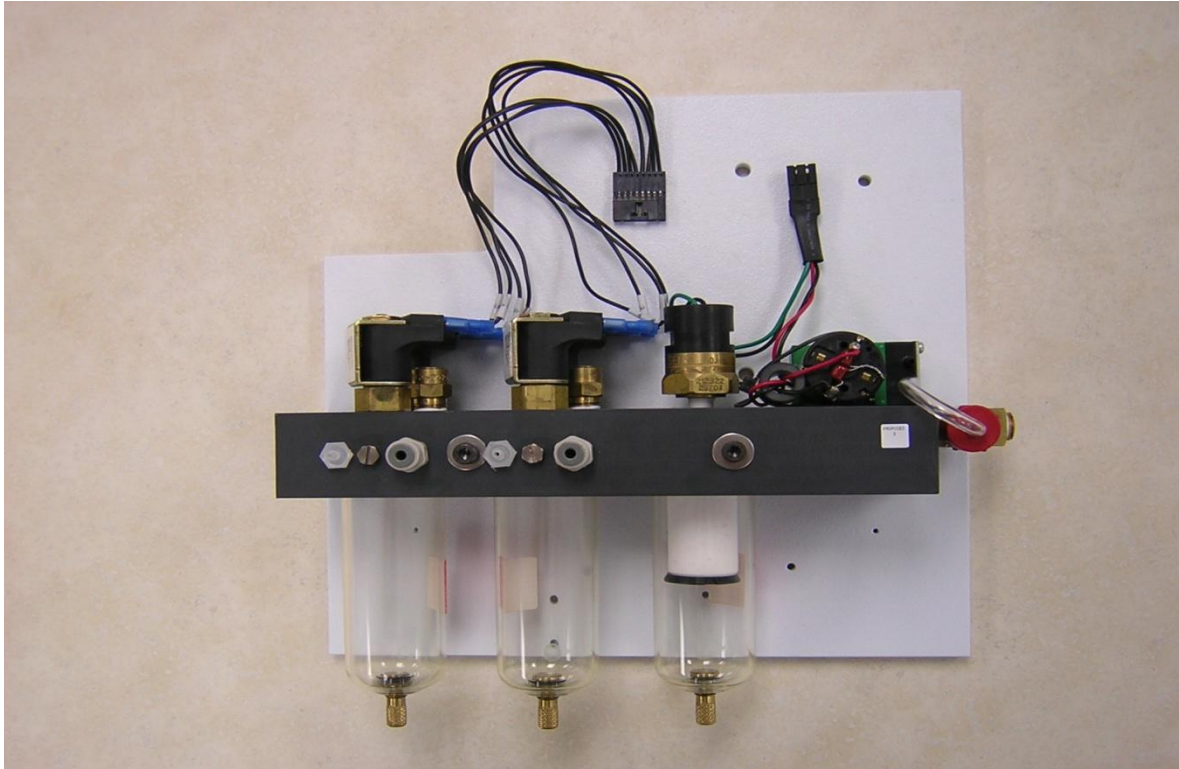

Retro Fit Kit: 78399-779

Use this part number to update Leak Test assembly on DSD-201's originally manufactured with the original" leak test assembly ASM1-0080 (previous page).

## DSD Front View

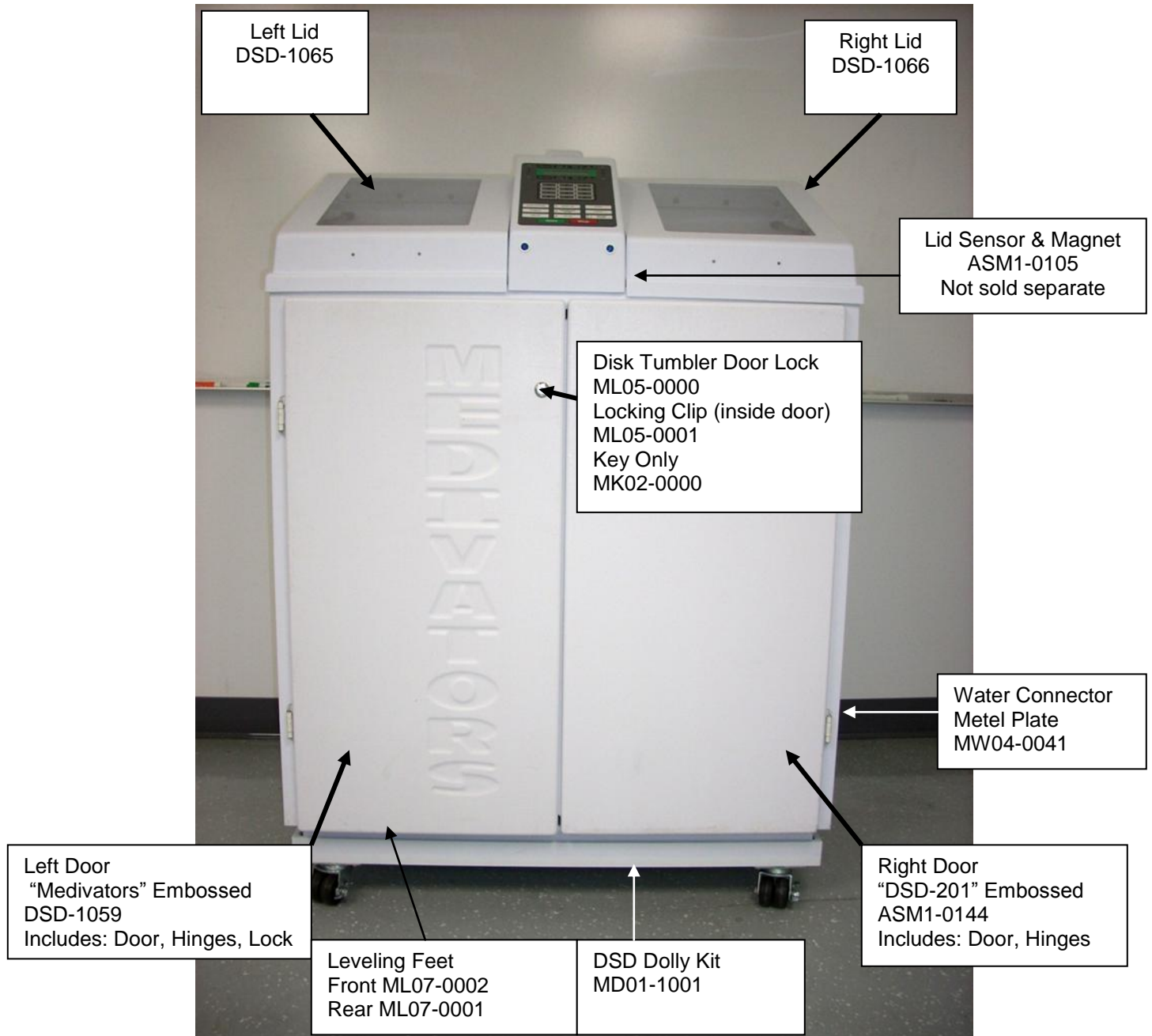



## DSD Top View

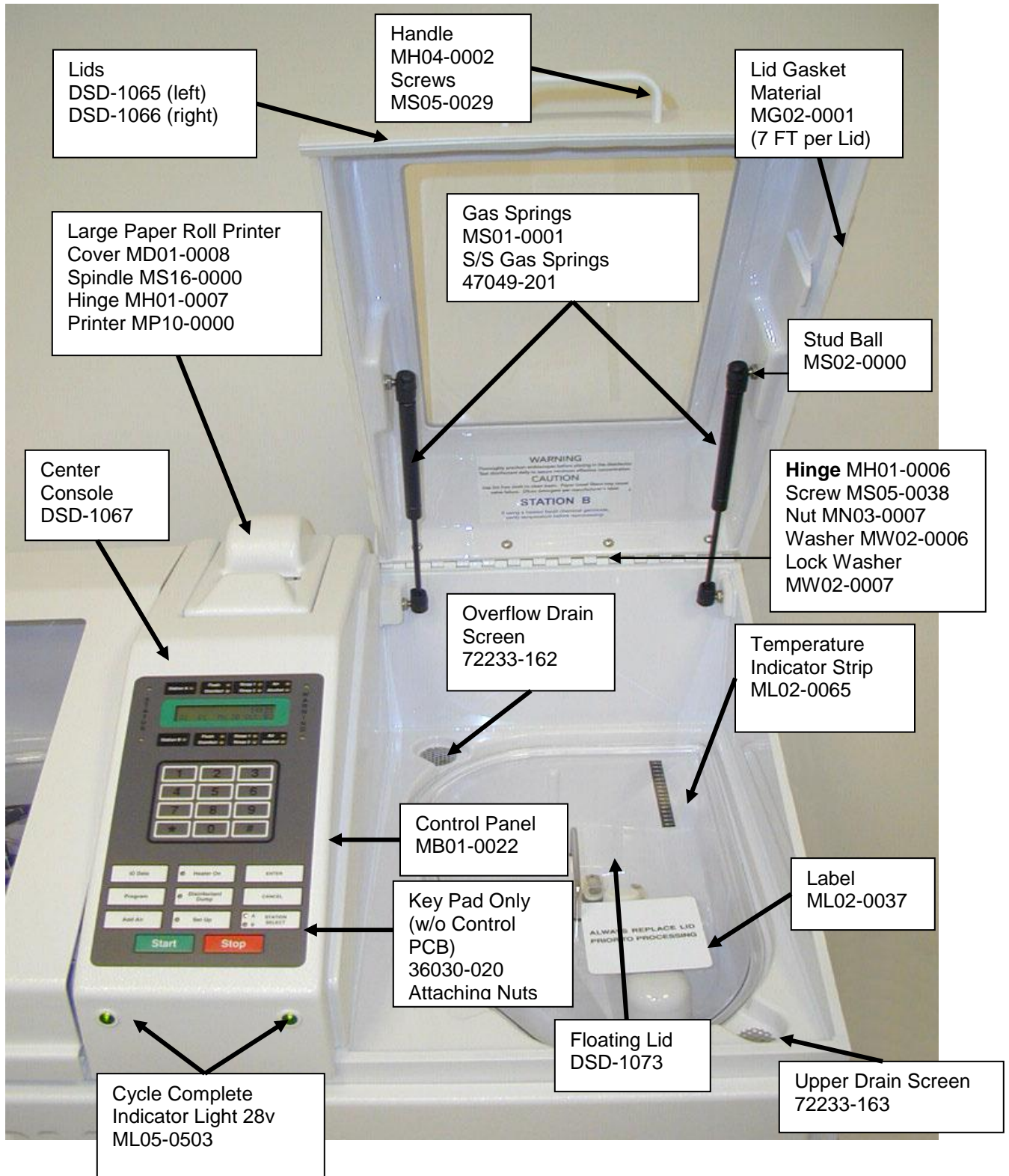



## Upper Basin – Top View

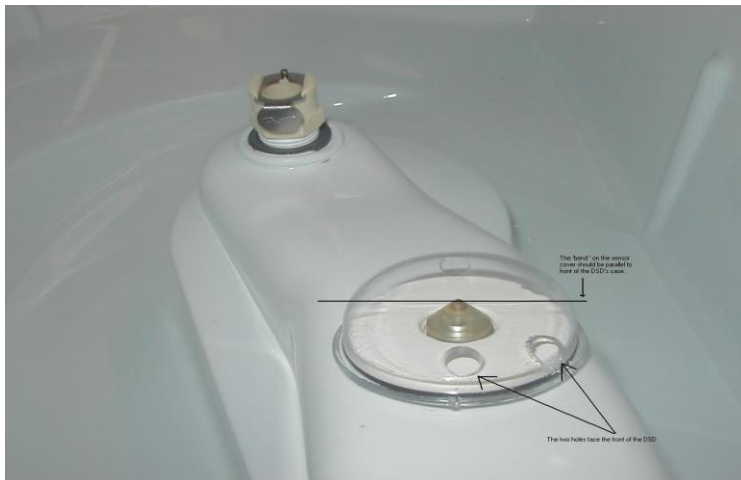
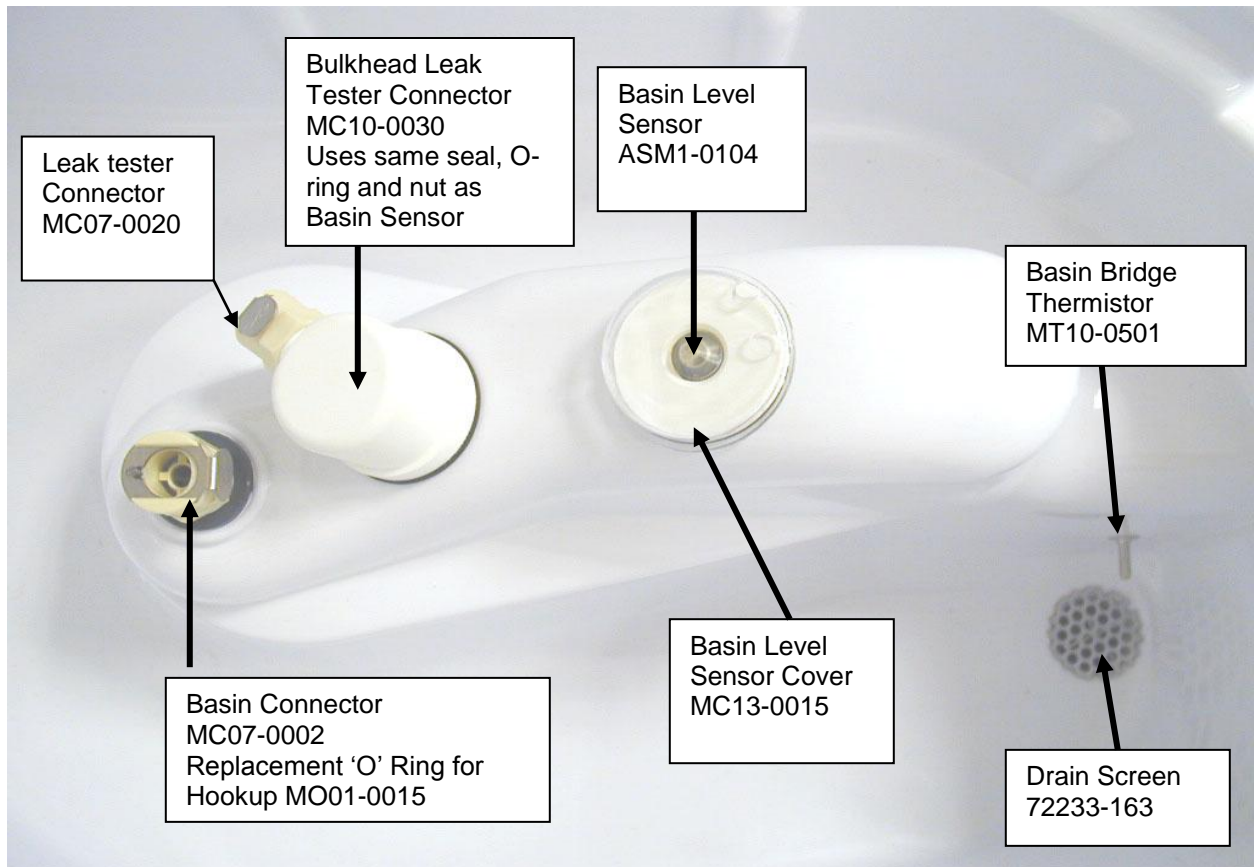

Correct orientation of  
Basin Sensor Cap

View from Front of DSD-201

Basin Restrictor: ASM1-0137 (not pictured – used for loading, dumping LCG)

## Basin, view from bottom

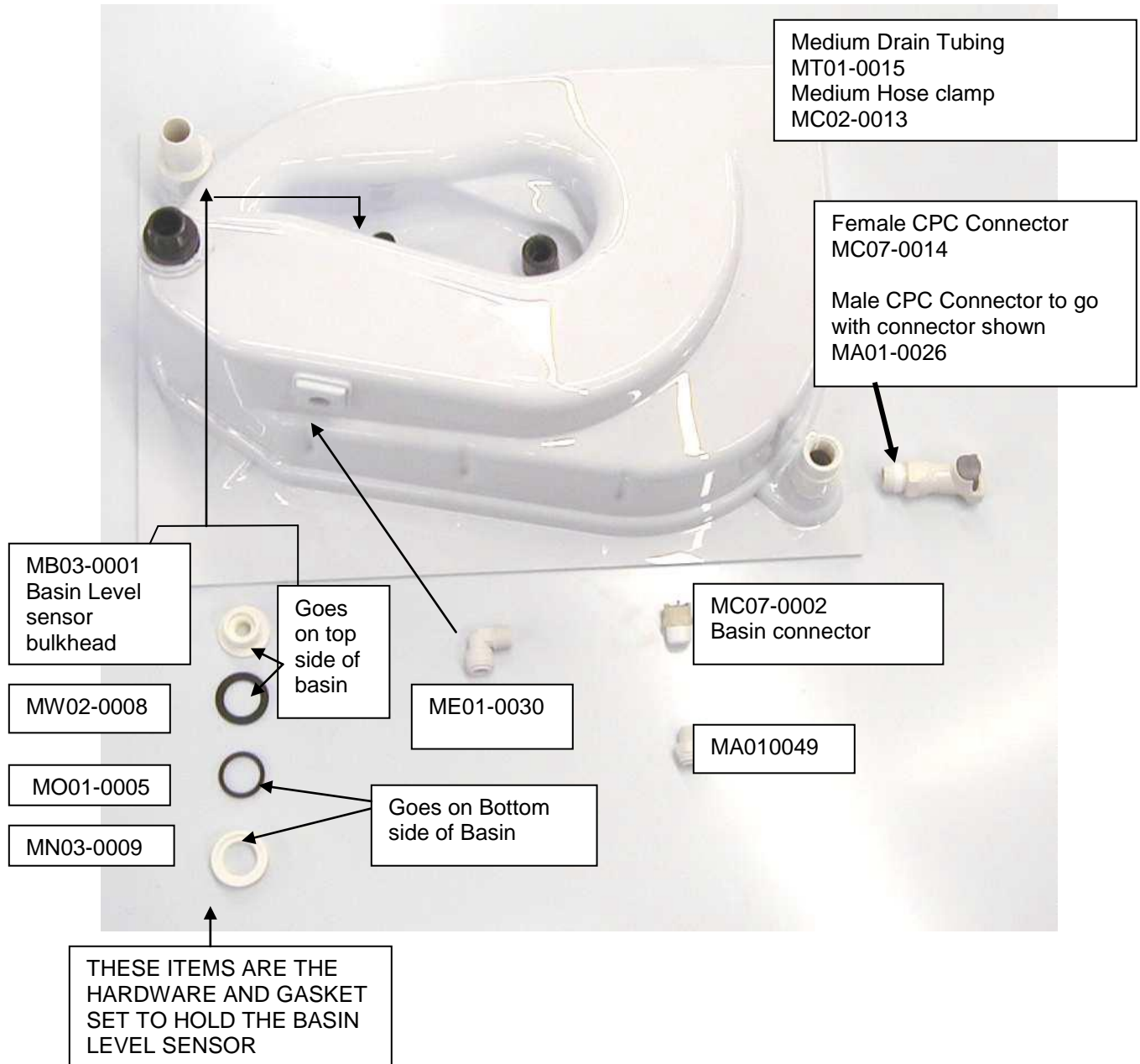

Basin Sensor Tool: ASM1-0145 (not pictured) – Used to remove the retention collar MN03-0009

### 3/4" Basin Drain Valve Manifold First generation MV01-0022

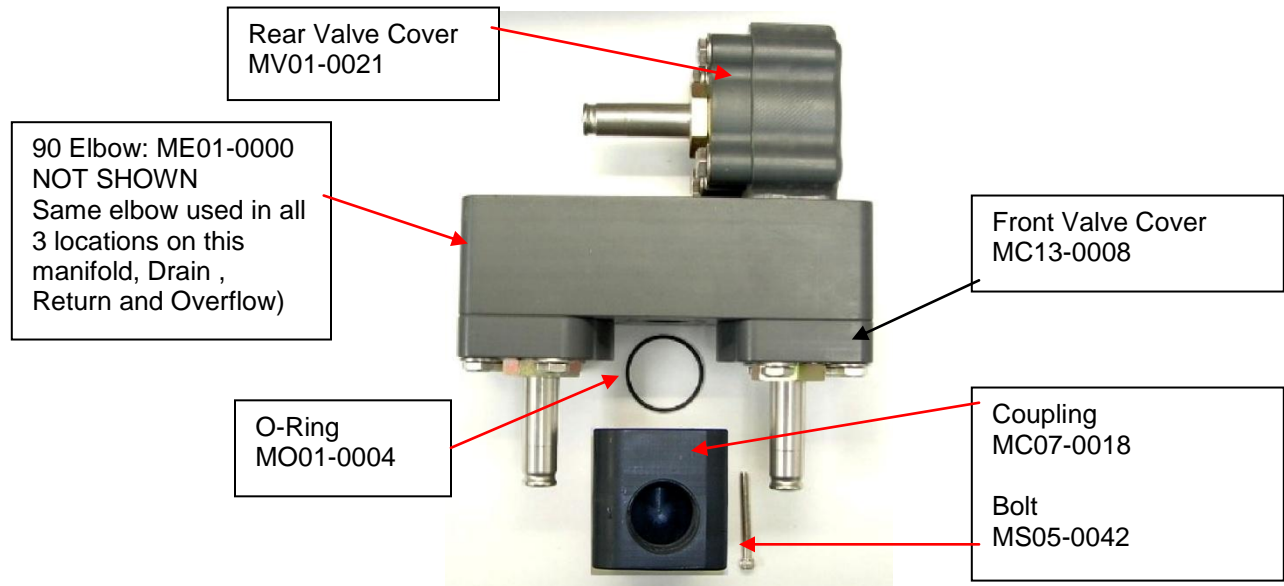

Valve Coil Assembly: MH05-0018

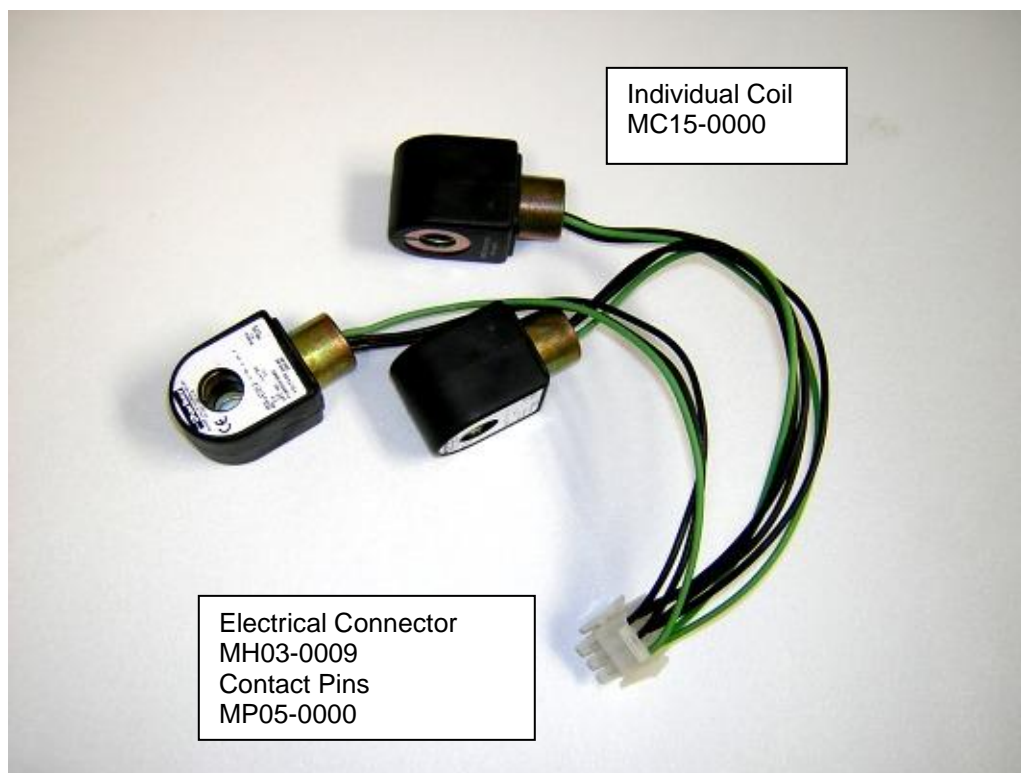

## 3/4" Drain Valve Assembly Breakdown MV01-0022

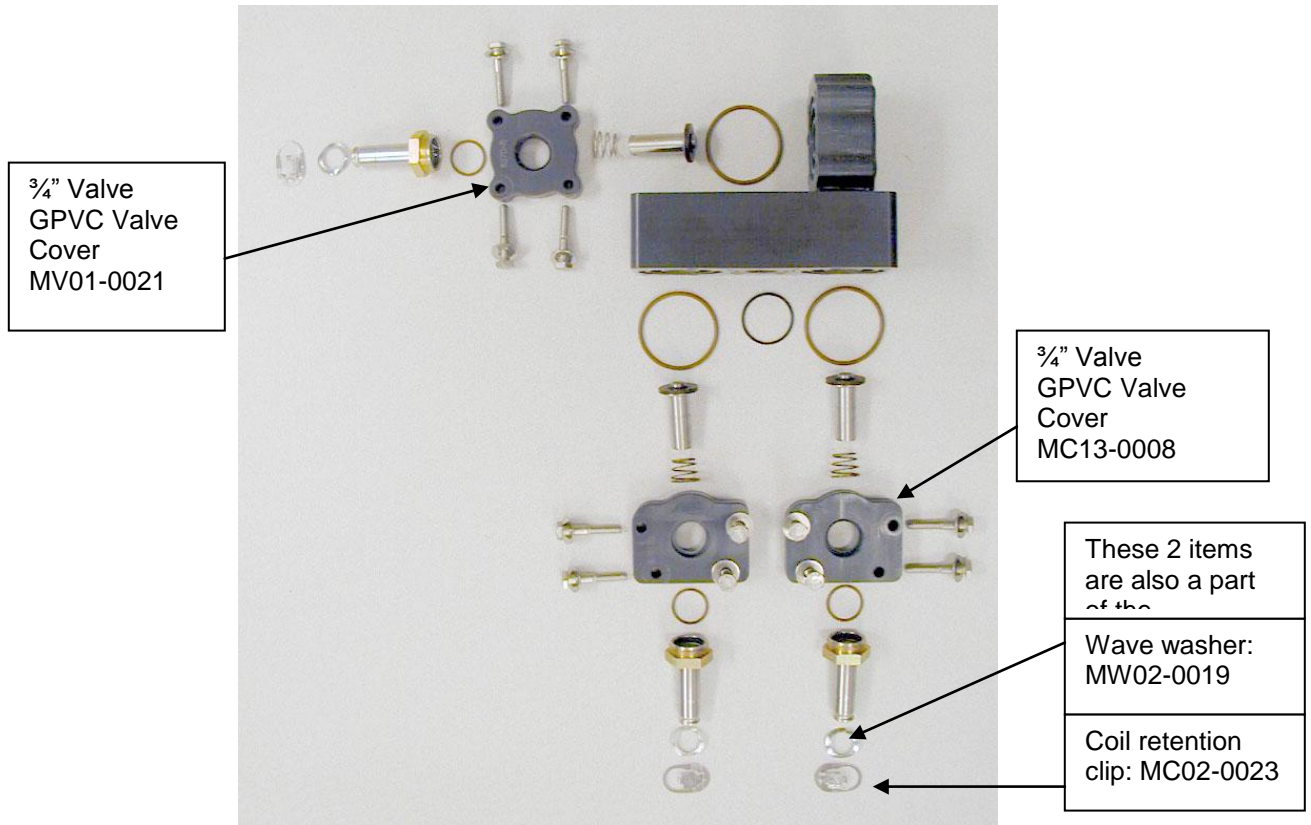

## Breakdown of the 3/4" valve rebuild kit –MK01-0029

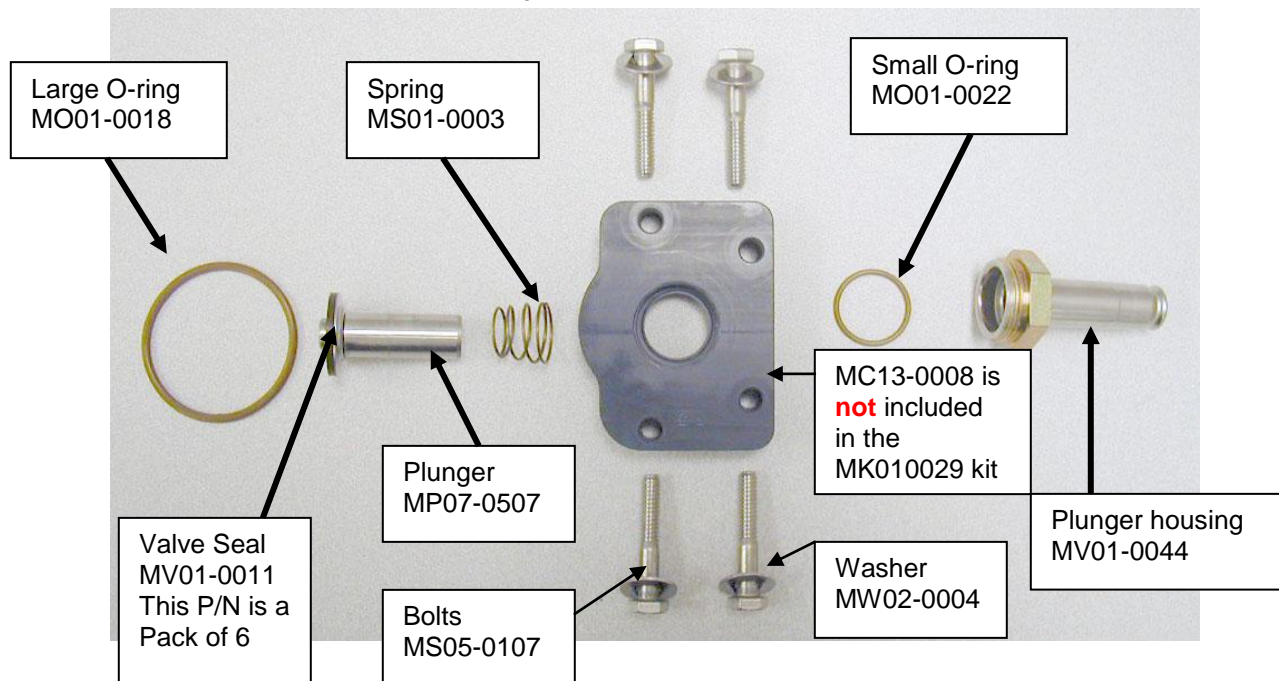



**3/4" Basin Drain Valve Manifold  
Second Generation  
78398-583**

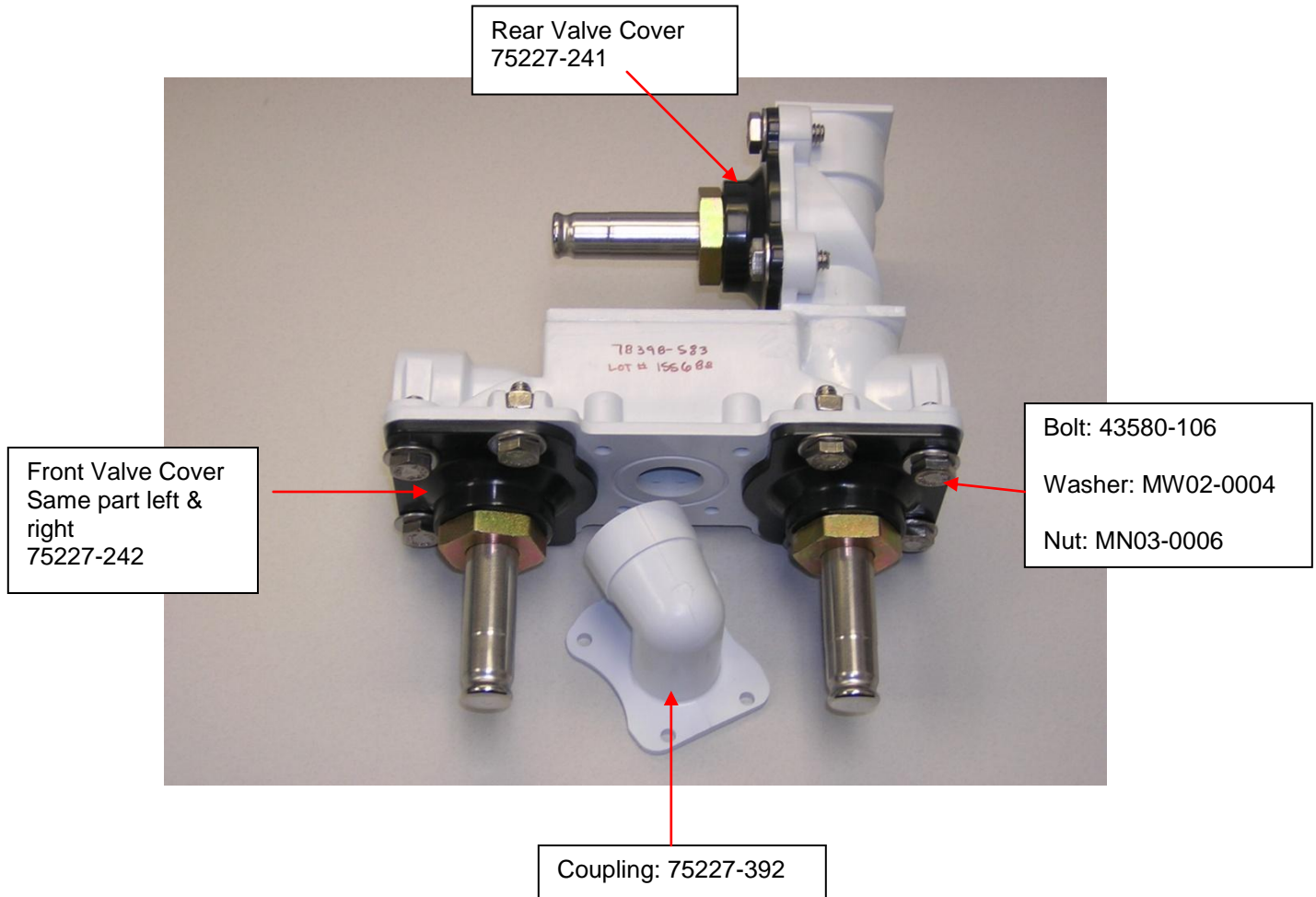

NOT PICTURED: The following hardware parts are used to attach the coupling to the manifold:

Bolts

43580-104

Qty 4

Lock Washers

MW02-0007 Qty 4

O-Ring

MO01-0004

Qty 1

NOTE: This coupling elbow has been updated, see next page.



Basin coupling elbow: PN 75227-392

Includes the o-ring and spacer. Currently the only elbow available for the white manifolds

Can be used on any white manifold, regardless of valve type. Cannot be used on older gray bodied manifolds.

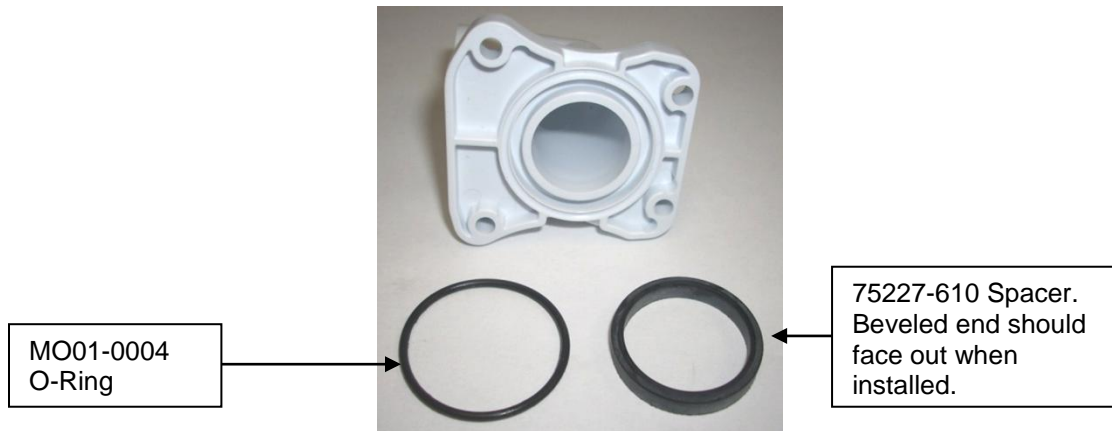

## 78400-661 Valve Manifold Third Generation

Includes Valves, Coils and Screws and basin elbow  
Everything you see here

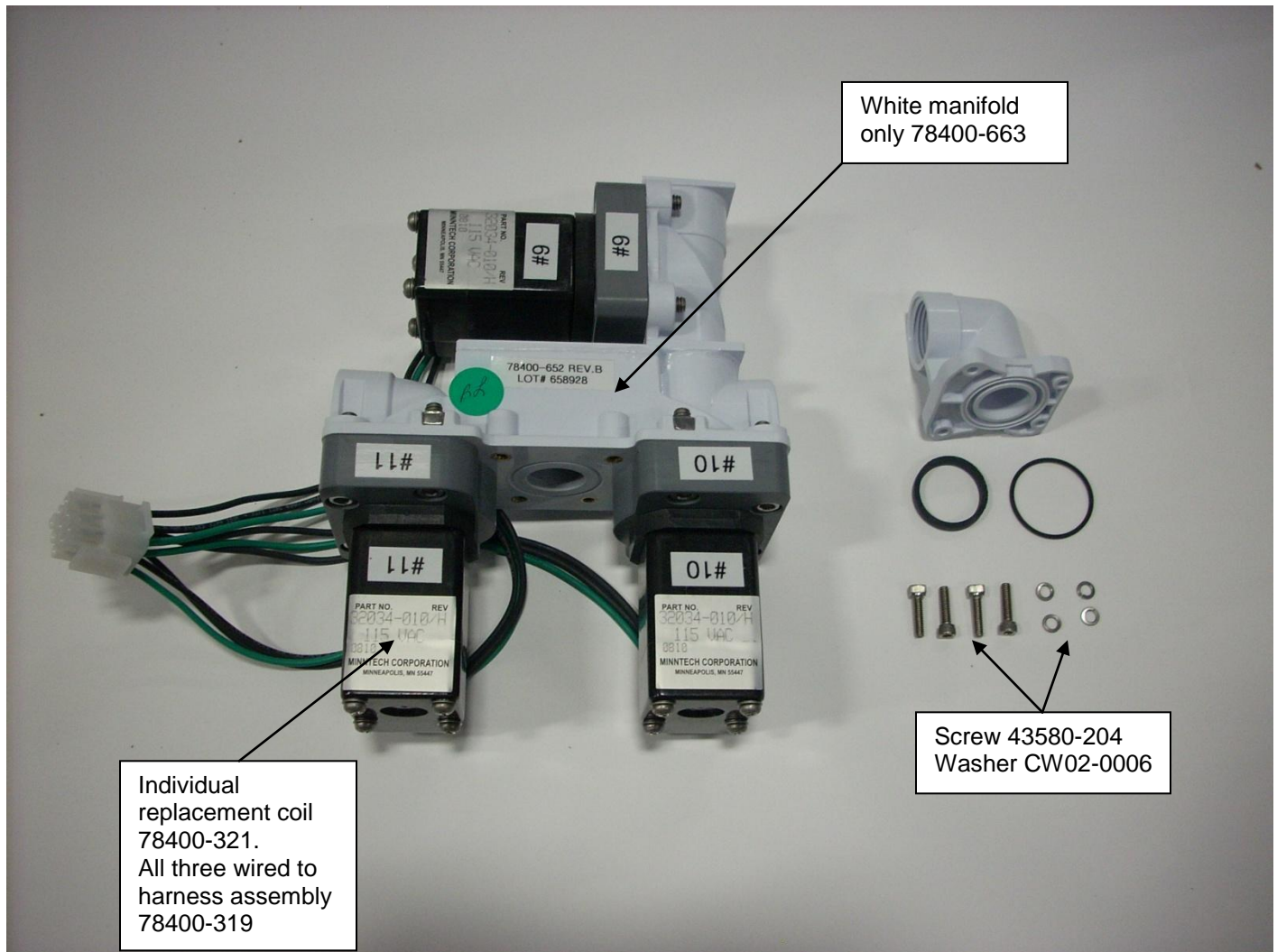

## Valve Rebuild Kits



Valve Rebuild Kit (Drain/Return)  
78400-658 (Valve 10 & 11)



Valve Rebuild Kit (Overflow)  
78400-659 (Valve 9)

Valve Spring: 47049-507  
(Comes with rebuild kit, but can be ordered separate)

Elbow for all  
drain manifolds  
ME01-0000

1" hose (not  
shown) that  
connects to the  
elbow

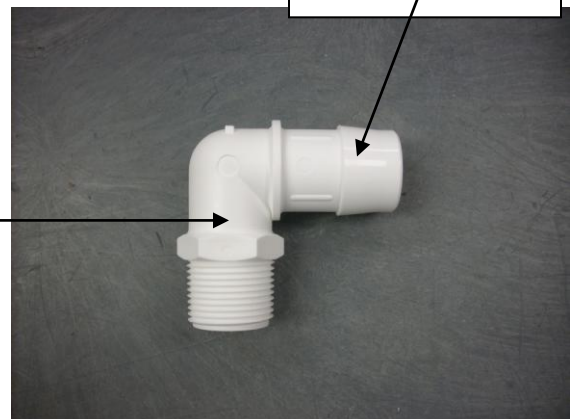



## Station A Main Module Sub Assembly ASM1-0113

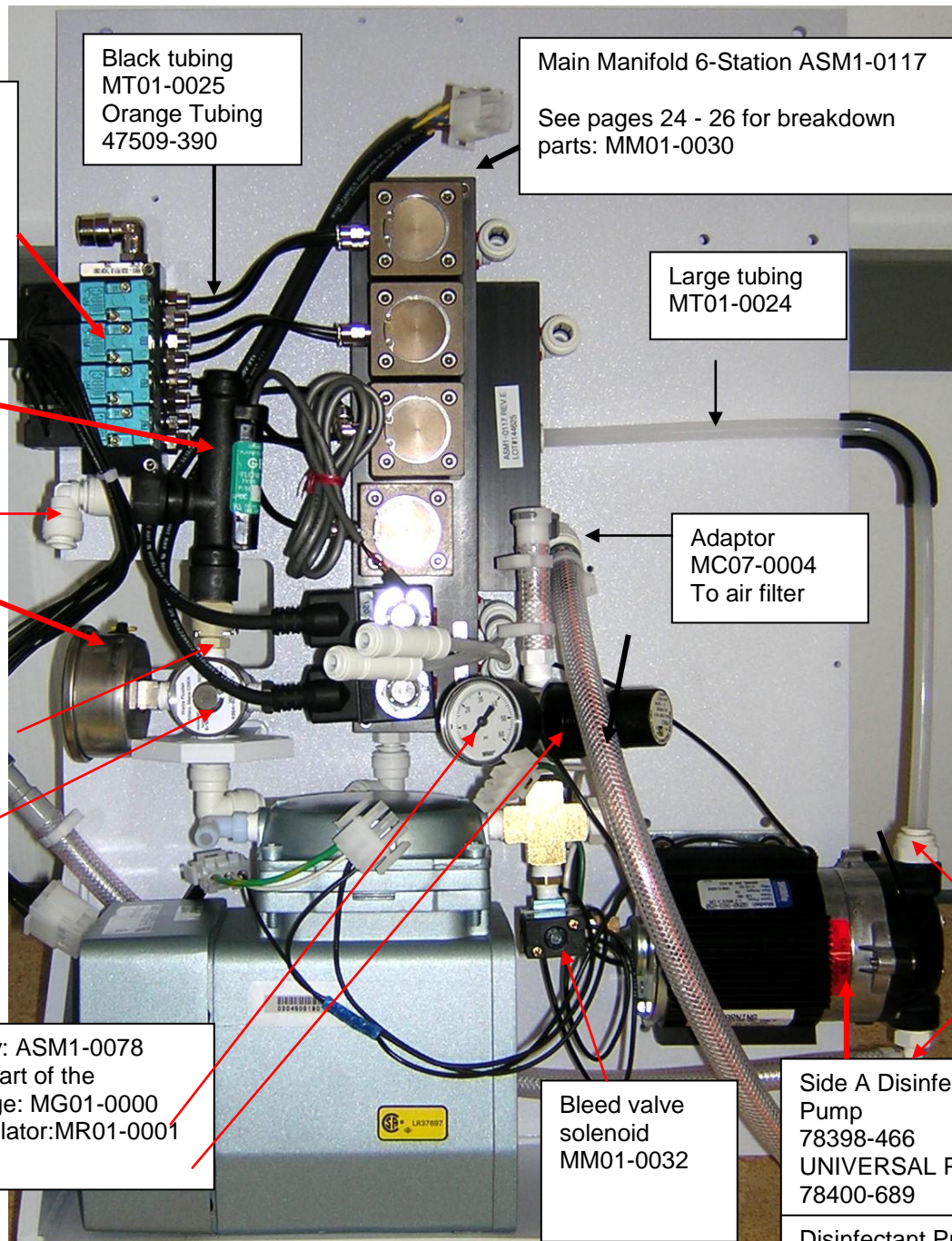

Air / Valve  
Manifold  
4-Station  
MM01-0028  
Individual MAC  
Valve replacement  
41600-109

Flow Sensor  
ASM1-0098

Elbow  
ME01-0026  
Adaptor  
MA01-0026

Regulator  
Assembly  
ASM1-0085

CPC Coupling  
Male:MC07-  
0007  
Female:

SS Regulator  
Assembly  
ASM1-0085

Black tubing  
MT01-0025  
Orange Tubing  
47509-390

Main Manifold 6-Station ASM1-0117

See pages 24 - 26 for breakdown  
parts: MM01-0030

Large tubing  
MT01-0024

Adaptor  
MC07-0004  
To air filter

Adaptor  
MA01-0049  
Elbow  
ME01-0005

Air Compressor Assy: ASM1-0078  
The following are a part of the  
assembly: Gauge: MG01-0000  
Regulator:MR01-0001

Bleed valve  
solenoid  
MM01-0032

Side A Disinfectant  
Pump  
78398-466  
UNIVERSAL PUMP  
78400-689

Disinfectant Pump head  
Replacement kit  
47049-193

## Station B Main Module Assembly ASM1-0115

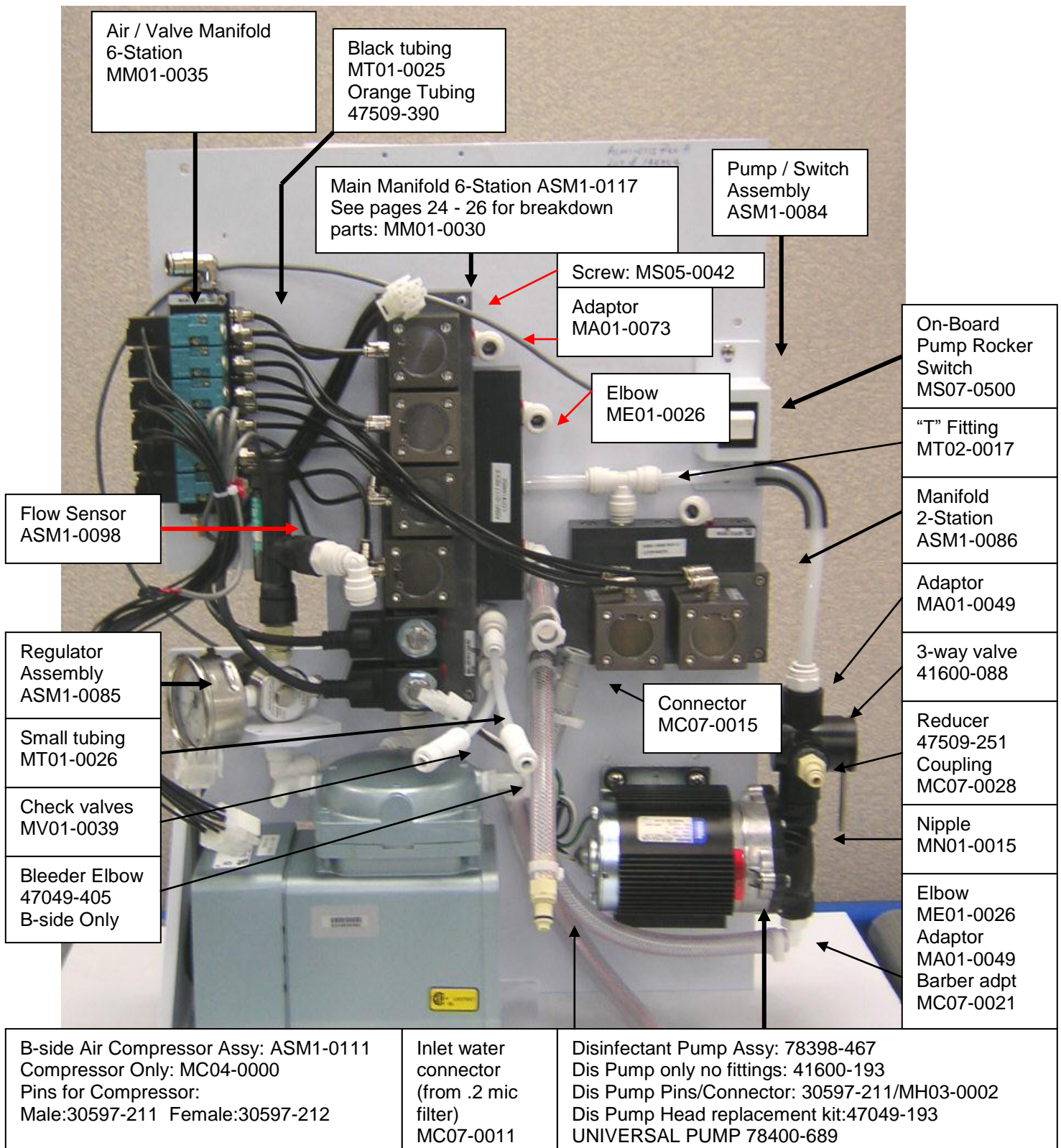



Main 6 Valve ManifoldMM01-0030  
(Includes all items pictured on this assembly)

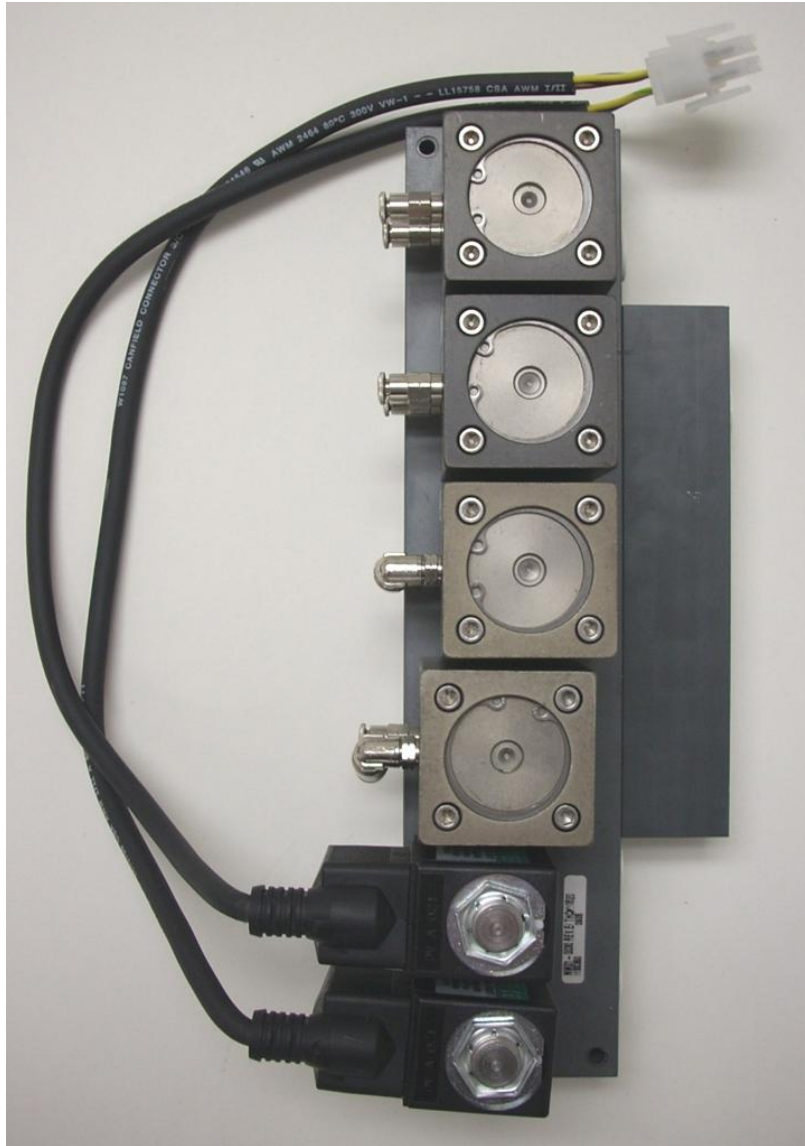

## Breakdown Of Main 6 Valve Manifold MM01-0030

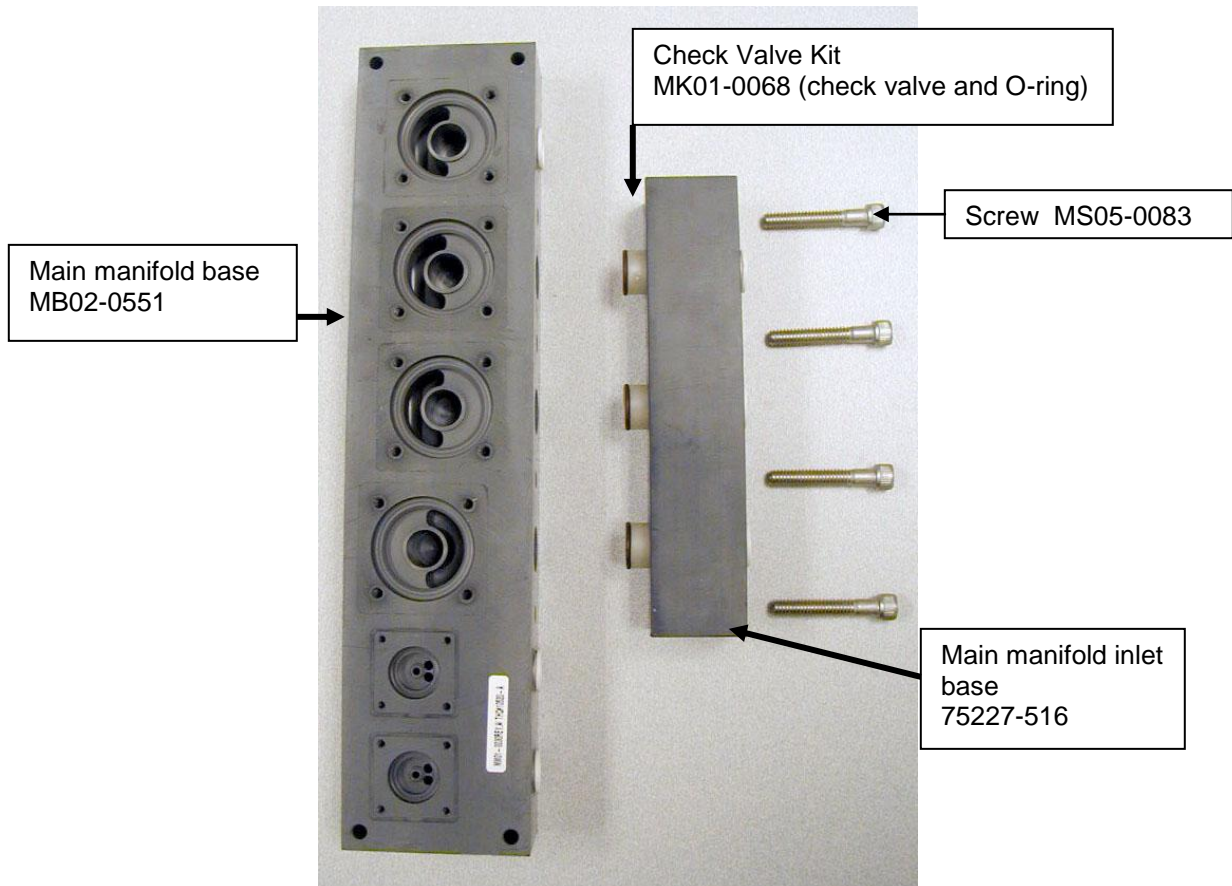

## Pneumatic Valve Assembly

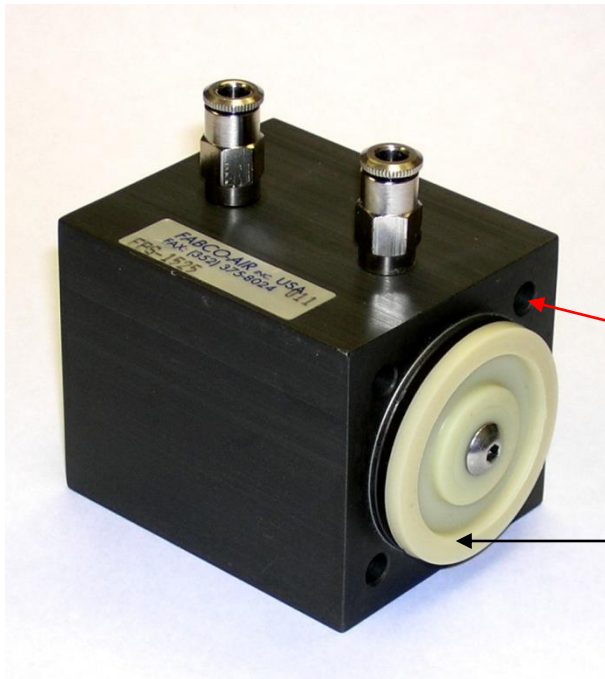

Valve block assy  
With straight  
connections  
41600-123

Screw: MS05-0085  
Holds valve to manifold

Valve seal kit  
78398-538  
Contains:  
4 Seals  
4 Screws  
Tube of Loctite

Valve Stem Wrench  
MW03-0002  
John Guest Tool 47049-157



Valve block assy  
With angled  
connection  
41600-124

Elbow: ME01-0033  
Straight: Not Available

## Alcohol / Detergent Valves

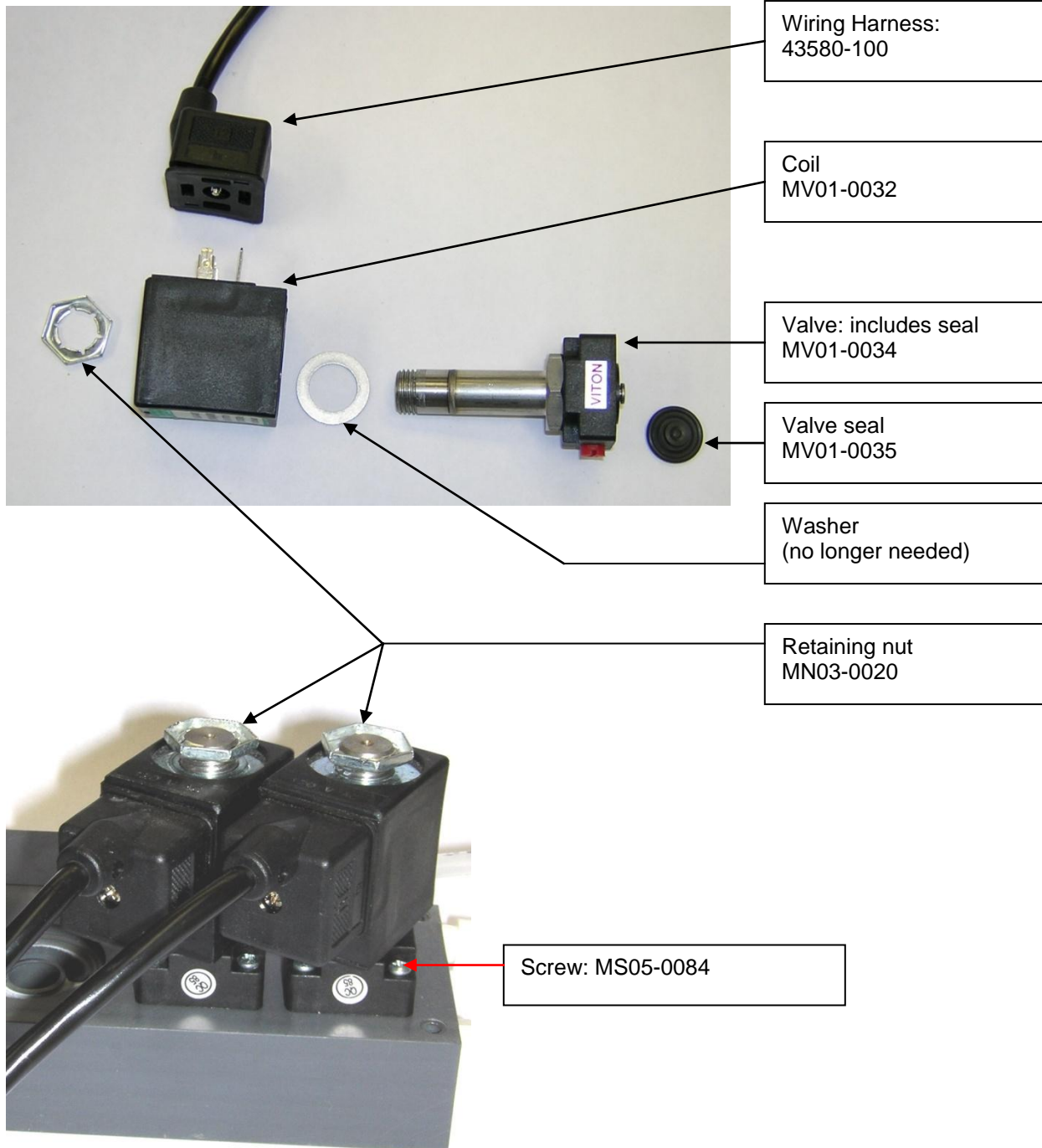



## 2 Valve Manifold ASM1-0086

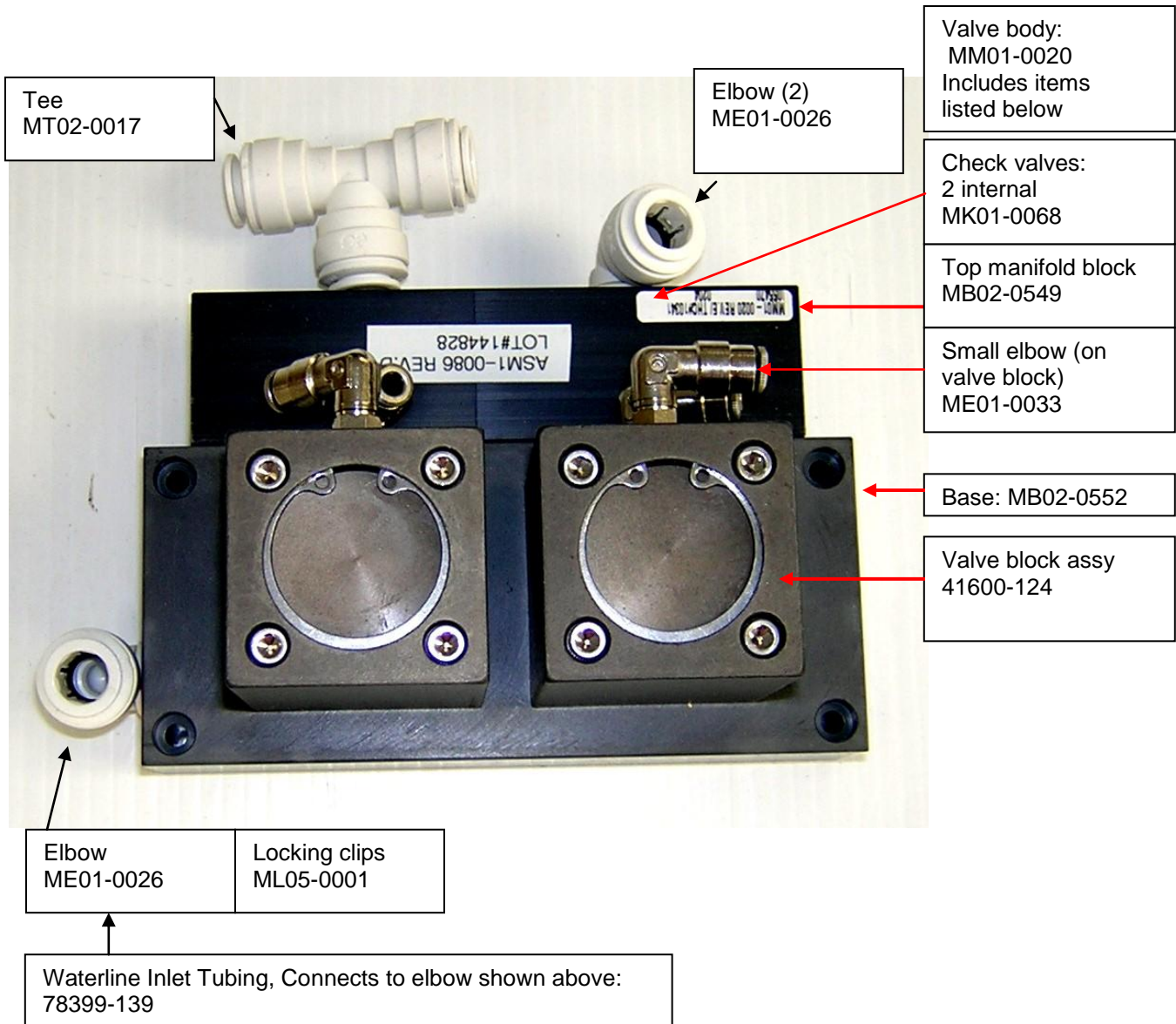

## Alcohol / Detergent and internal .2 Micron water filter Assembly

ASM1-0127: This is the Alcohol & Pump assembly

ASM1-0128: This is the Detergent & Pump and .2 micron filter assembly

ASM1-0166: This is the Alcohol/Detergent bottle sub assembly used on the above assemblies.

The .2 micron filter water housing does not have a sub-assembly part number.

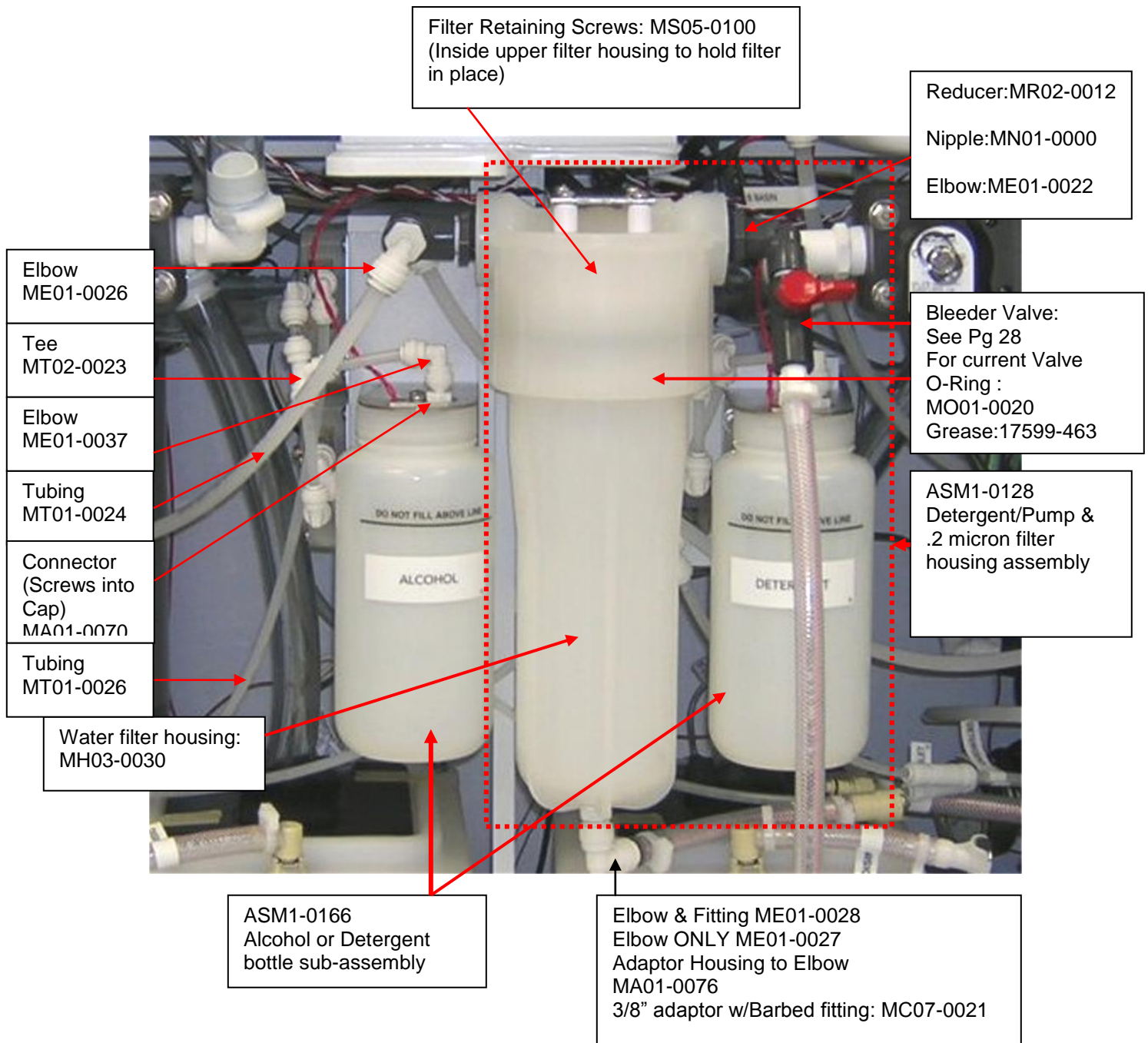

## Water Filter Housing, Blue Bleeder

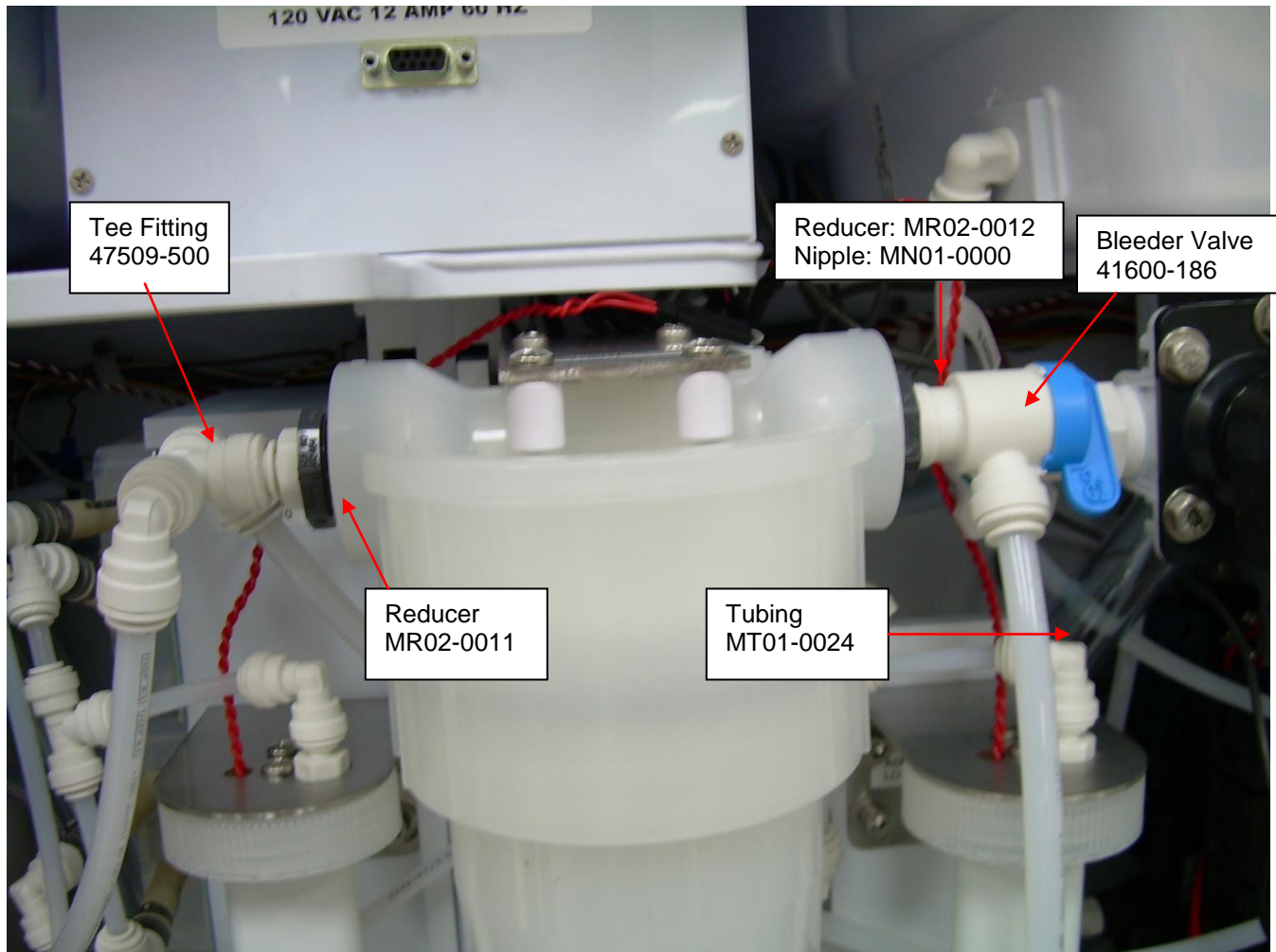



## Plastic Filter Housing: MK01-0071 Replacement for Stainless Steel Filter housing

Other parts Needed:

ME01-0027 Qty 1

MT01-0024 Qty 4 Ft Tubing

MK01-0071 is designed for the DSD-91E. To install in the DSD-201, contact Medivators Technical Support @ 800-444-4729.

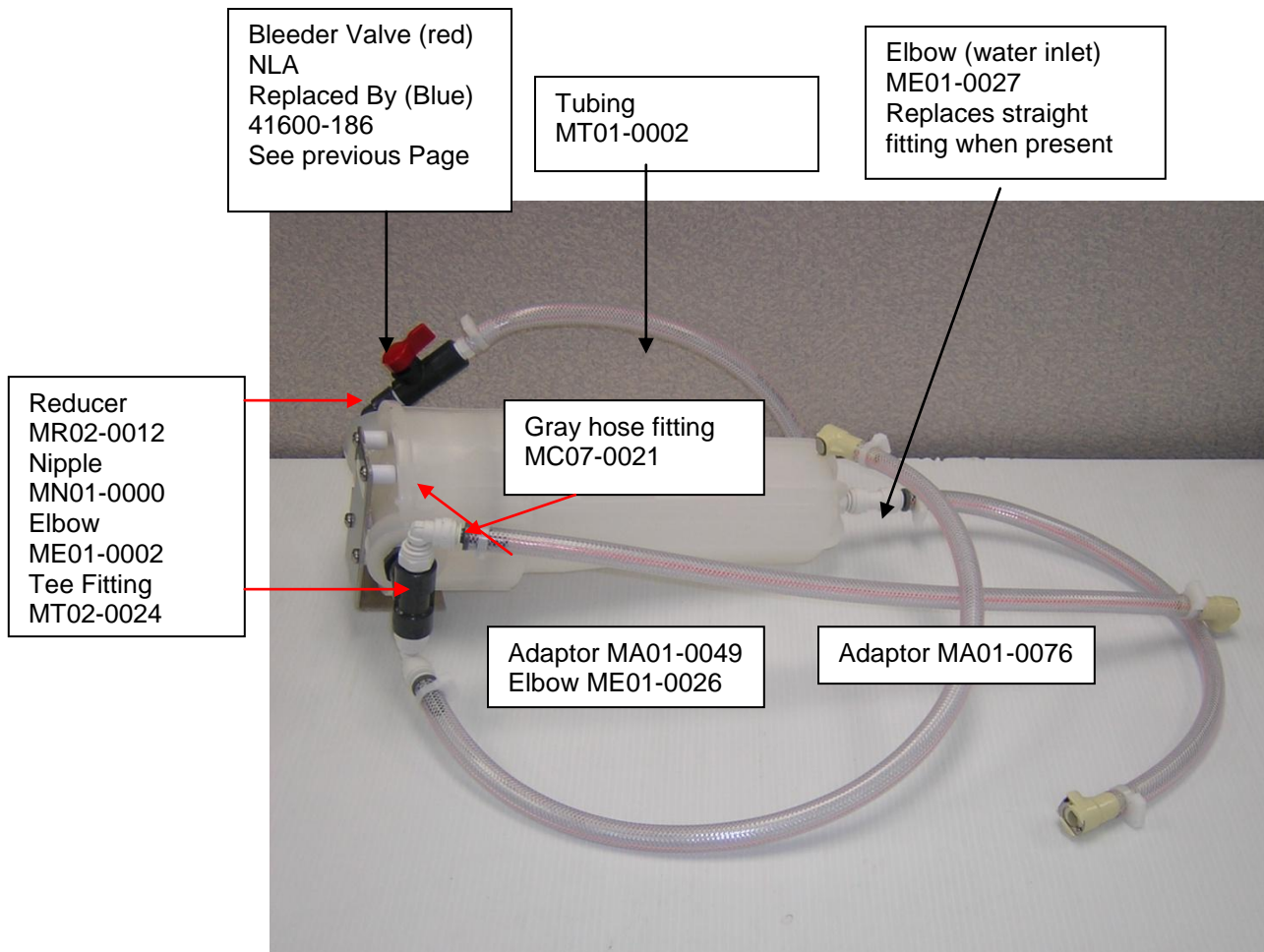



## Alcohol / Detergent Bottle Sub-Assembly ASM1-0166

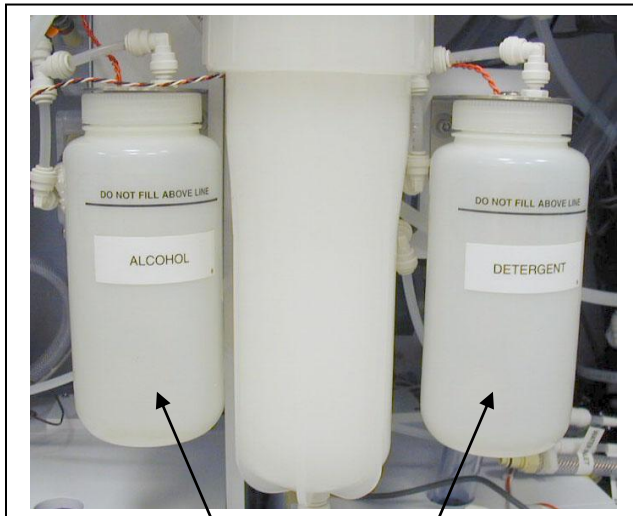

Alcohol/Detergent  
Receptacle  
MR06-0004

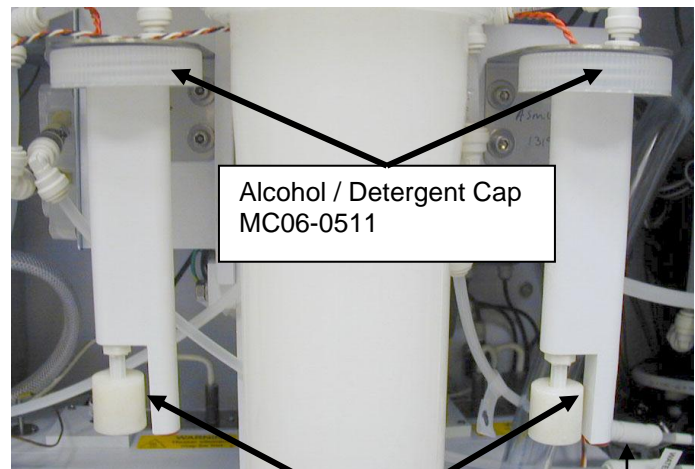

Alcohol / Detergent Cap  
MC06-0511

Float Sensor  
Wiring Connector  
MH03-0031  
Pins  
MP05-0011

Alcohol / Detergent  
Float Sensor  
MS03-0011

Check Valve (Red)  
MV01-0040

### Peristaltic Pump

Peristaltic Pump  
Tube Set (4)  
MT01-0500

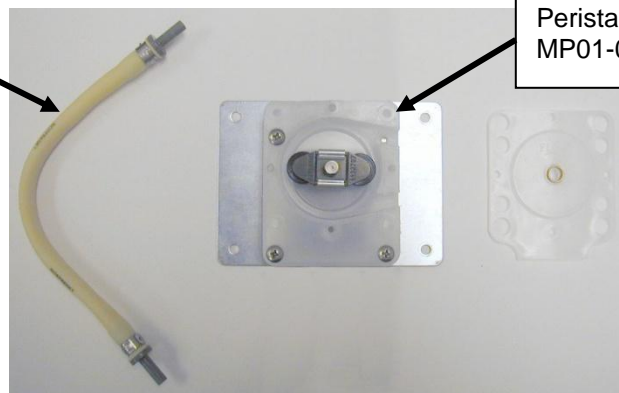

Peristaltic Pump  
MP01-0013

## Original internal water filter housing **OBSOLETE**

Elbow  
ME01-0027

3/8 Adaptor  
w/Barber Fitting  
MC07-0011

This Stainless Steel .2  
micron water filter  
housing is  
**OBSOLETE.**

O-Ring for This  
Housing:  
43100-091

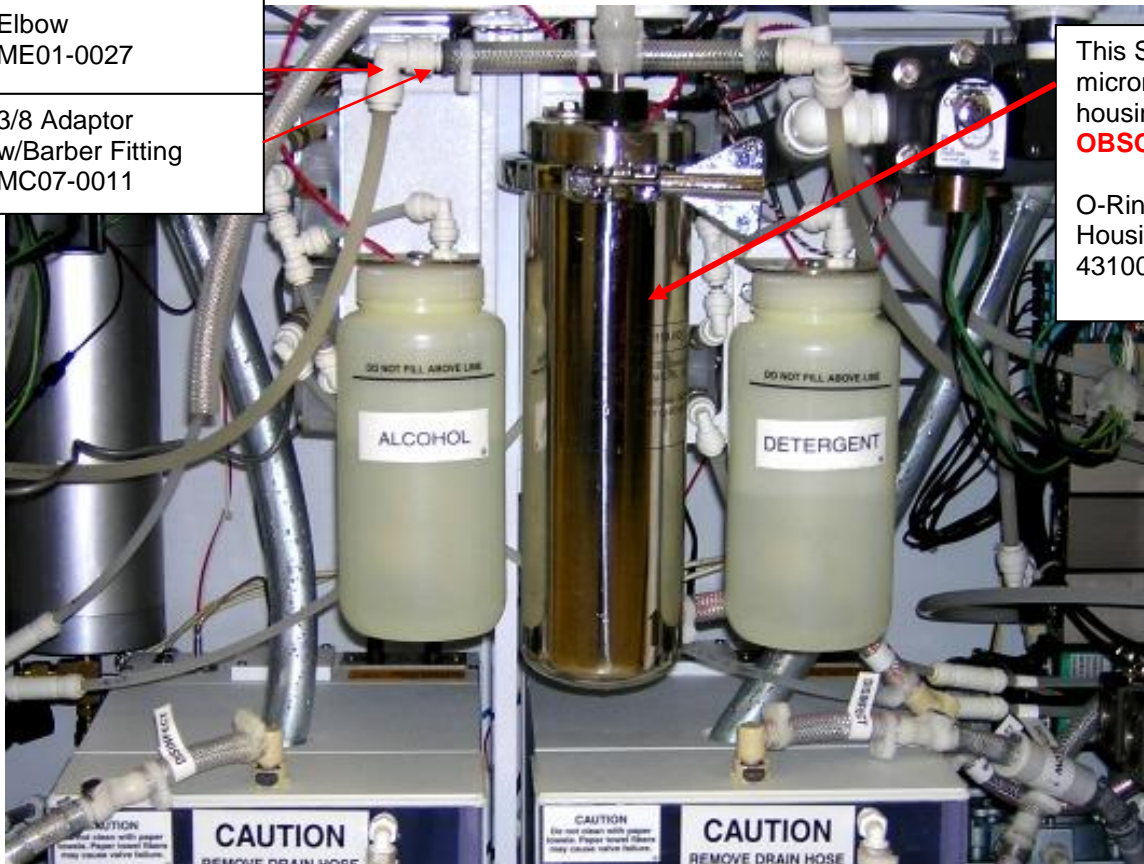

Original LCG Reservoir Assembly **OBSOLETE**  
Reservoir tank with heat





## LCG Reservoir Assembly - Second Generation

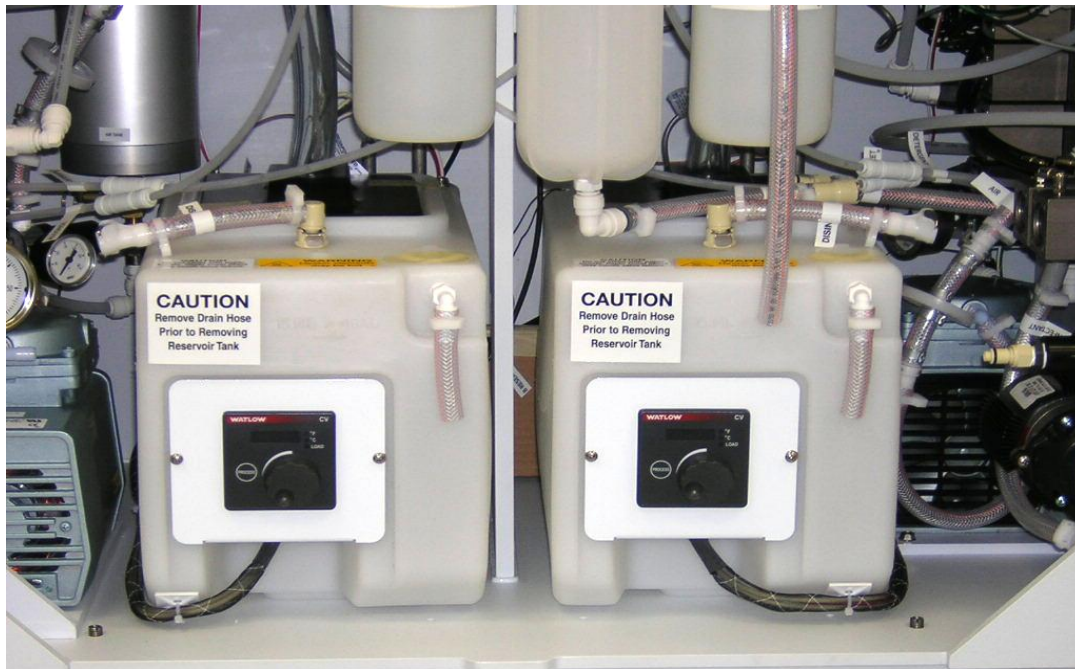

Side A Heated LCG reservoir tank:  
78398-647

Side B Heated LCG reservoir tank:  
78398-842

Male CPC Elbow  
ME01-0018  
Female CPC Connector  
(Now stainless steel)  
47509-663

Uptake Tube  
78399-249

Caution label  
(remove drain hose)  
67198-532

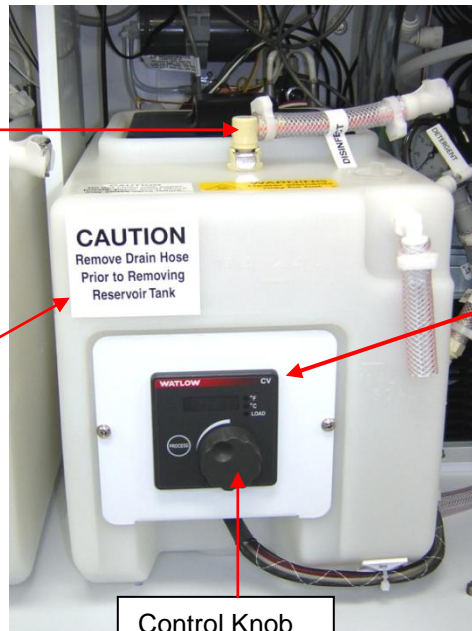

Control Knob  
39500-065

Digital temperature  
controller  
39500-020

Digital Temp Control Kit  
(Includes mounting  
Hardware)  
78399-131



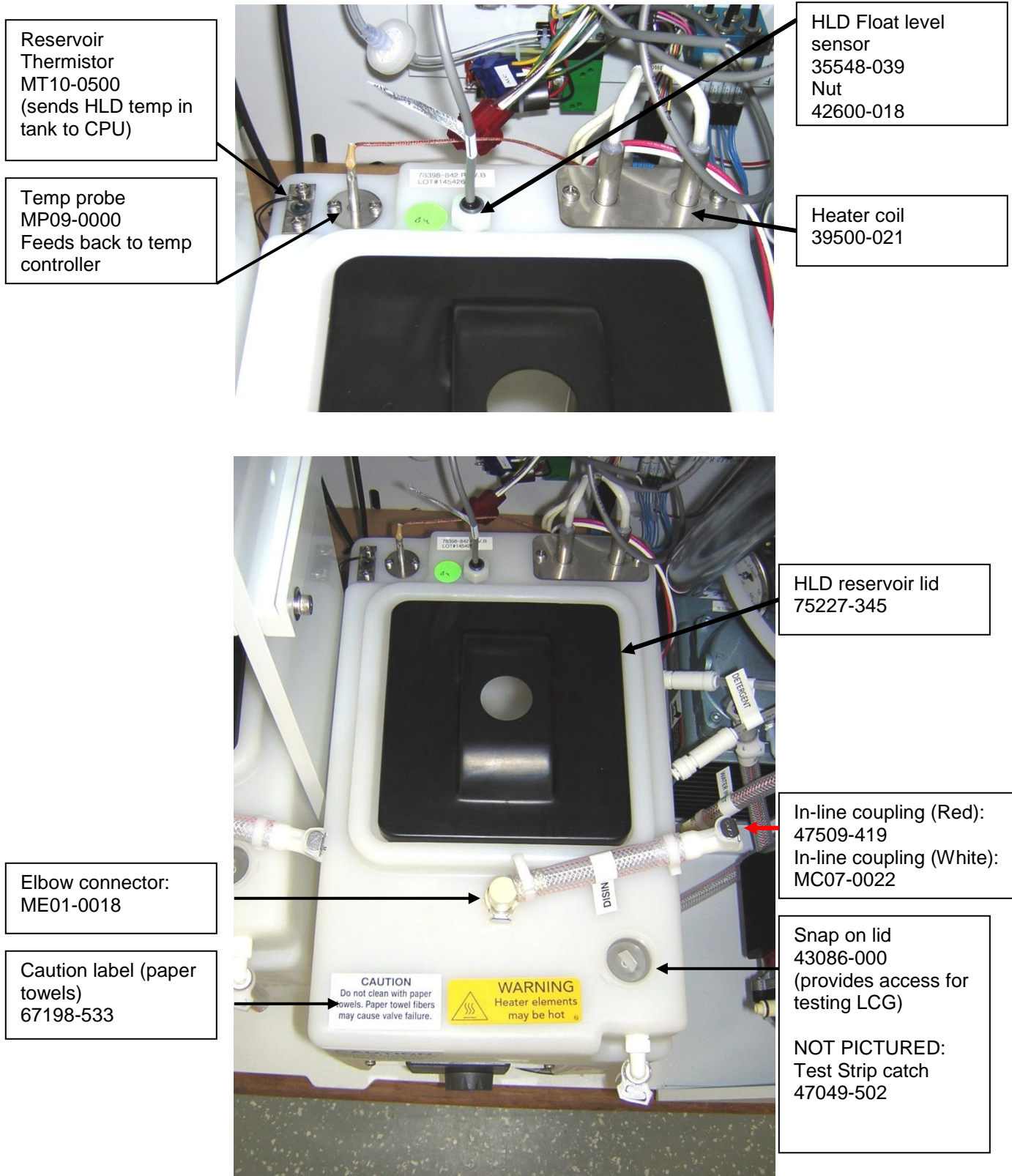

## MT03-0023 Air Tank Assembly

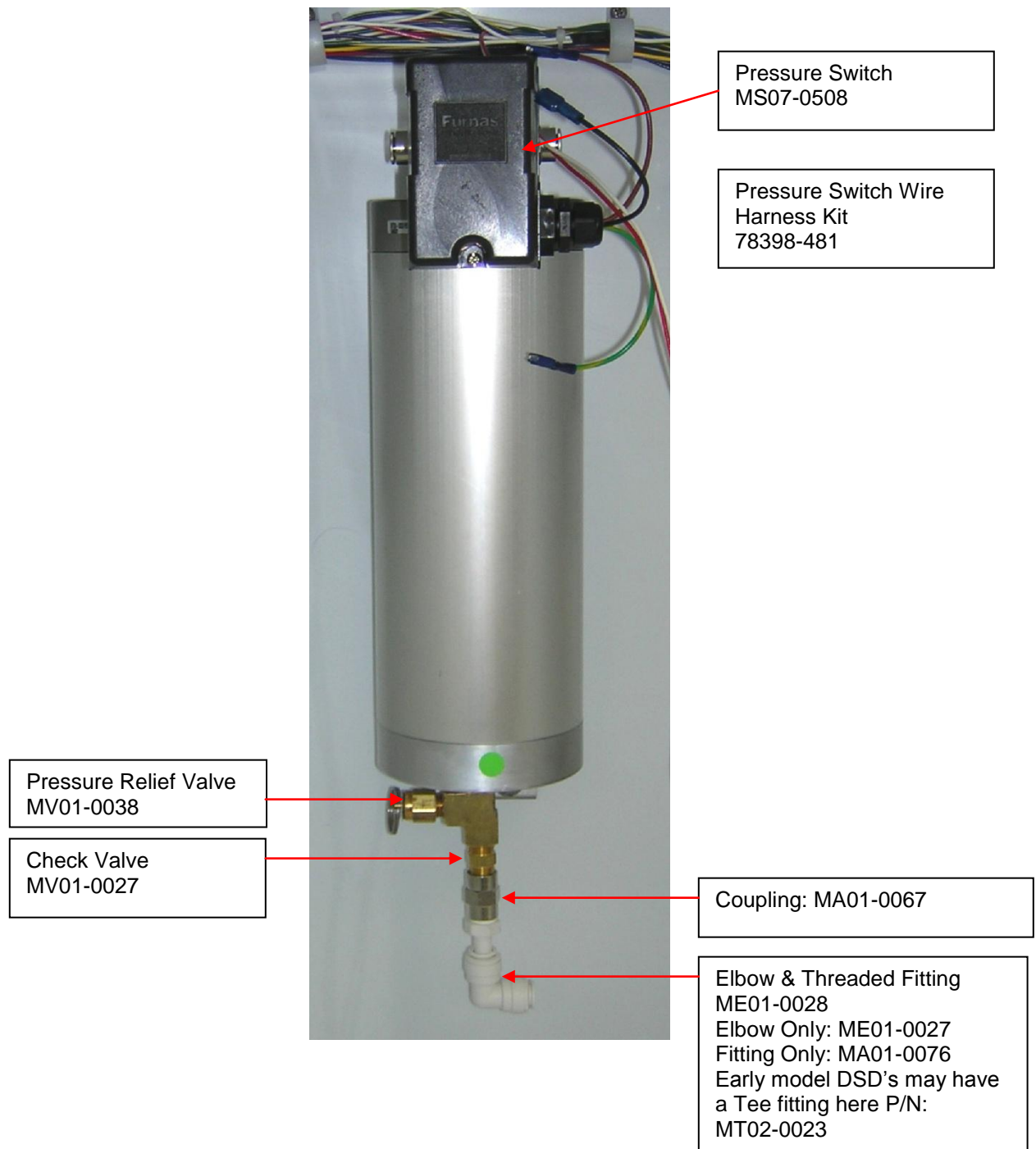

GFI Assembly

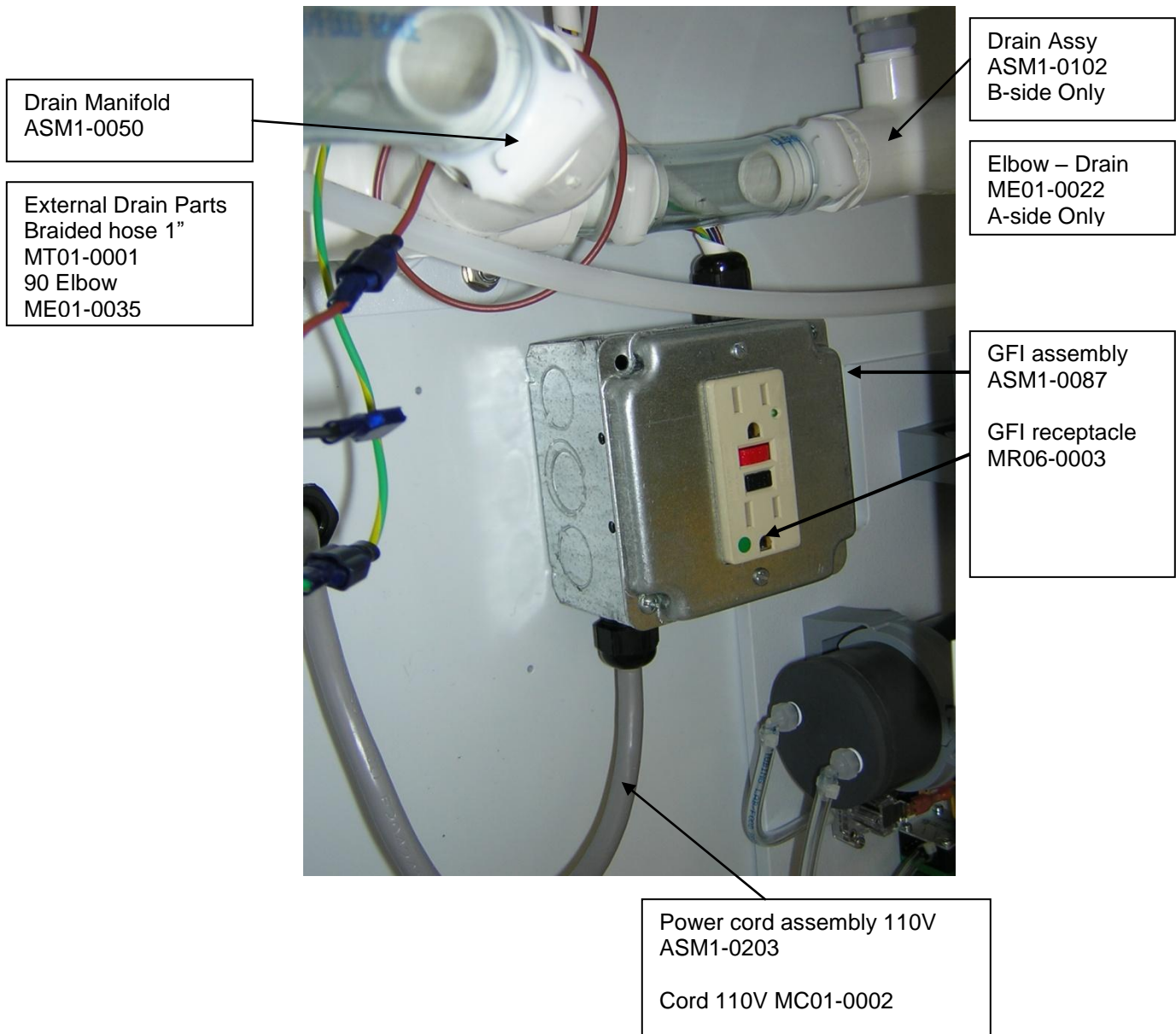

Other items not pictured

External water Regulator & Gauge  
Regulator: MR01-0005  
Gauge: MG01-0001

External Water pre-filtration kit:  
78399-991 – Includes installation hose and Regulator

DSD Drain Hose: MT01-0001



Minntech Corporation  
14605 28th Avenue North  
Minneapolis MN 55447  
Tel: +1-763-553-3300  
Fax: +1-763-553-3387  
[www.minntech.com](http://www.minntech.com)

Minntech Asia/Pacific Pte Ltd  
438 Alexandra Road  
#03-01 Alexandra Point  
Singapore 119958  
Tel: +65-6227-9698  
Fax: +65-6225-6848

Minntech BV  
Sourethweg 11  
6422 PC Heerlen  
The Netherlands  
Tel: +31-45-5-471-471  
Fax: +31-45-5-429-695

Minntech China, Rep. Office  
Room 1508B, Avic Plaza  
No. 10 Yi Dongsanhuan Zhonglu  
Chaoyang District,  
Beijing 100022 China  
Tel: +86-10-6567-8446  
Fax: +86-10-6567-8445